

# Dehumidifier and air purifier



## Airbi SPONGE

### Instruction manual

(Version 1.0)



Please read the instruction manual carefully before using this appliance!

## Important safety instructions

---

Please read through the operating instructions carefully before you use the appliance for the first time and keep them safely for later reference. If necessary pass them on to the next owner.

1. The appliance is only to be used in the home for the purposes described in these instructions. Unauthorised use and technical modifications to the appliance can lead to danger to life and health.
2. This appliance can be used by children aged from 10 years and above and persons with reduced physical, sensory or mental capabilities or lack of experience and knowledge if they have been given supervision or instruction concerning use of the appliance in a safe way and understand the hazards involved. Children shall not play with the appliance. Cleaning and user maintenance shall not be made by children without supervision.
3. After unpacking, make sure that appliance wasn't damaged during transport. If you find any damage, contact your dealer as soon as possible. We recommend you keep the packaging for possible future use .
4. Before first use check that the device parameters (electric voltage, etc.) correspond to local conditions.
5. Ensure both the filter and its cover are properly installed before using.
6. Do not place the appliance near a heat source. Do not subject the power cord to direct heat (such as a heated hotplate, open flames, hot iron sole plates or heaters for example). Protect power cords from oil.
7. Always put the appliance on a hard, flat horizontal surface. There should be a gap of at least 30 cm at both sides and back of the product, while 50 cm from top surface.
8. Do not place anything on the appliance and do not block the air inlet and outlet.
9. Before using the appliance, check if power cord is not damaged. Do not use it if the cord is damaged.
10. If the power cord is damaged, it must be replaced by the manufacturer or a repair shop authorized by the manufacturer or by similarly qualified persons in order to avoid a hazard
11. Switch off and unplug the unit before cleaning, maintaining and replacing filter.
12. Do not lift or move the appliance when it is working.
13. Do not touch the power cord with wet hands, may cause electric shock.
14. Do not insert fingers or metal objects into the air outlet gap, may cause electric shock.
15. Do not let water, flammable detergent or other liquid get into the product, may cause electric shock of fire.
16. This product is not supposed to be used as daily ventilator, dust cleaner or cooker hood.
17. Do not use the appliance in aromatherapy scent insecticide environment.
18. Store the appliance in a dry place inaccessible to children (pack the appliance).
19. Manufacturer is not responsible for any damage due to improper use of appliance.

## Product's description

---

Do you know that wet and sticky feeling when walking into a basement? Although it's more common in basements, closets, laundry rooms and bathrooms, you might experience this in any part of your home. If any corner in your house is showing signs of excess humidity, consider the revolutionary dehumidifier with HEPA filter from Airbi. This is a combination of dehumidifier and air purifier to produce the driest and cleanest air possible. Loaded with desirable features including adjustable air purification levels and automatic full-tank shutoff. Its compact size and modern design ensure the dehumidifier quite pretty, taking up very little space. Now, get it home to improve the air quality you breathe with the wonder unit.

## Product's scheme

1. Control panel
2. Air outlet
3. Purification air inlet
4. Dehumidification air inlet
5. HEPA filter
6. Filter cover
7. Power cord
8. Water tank
9. Water outlet
10. Float

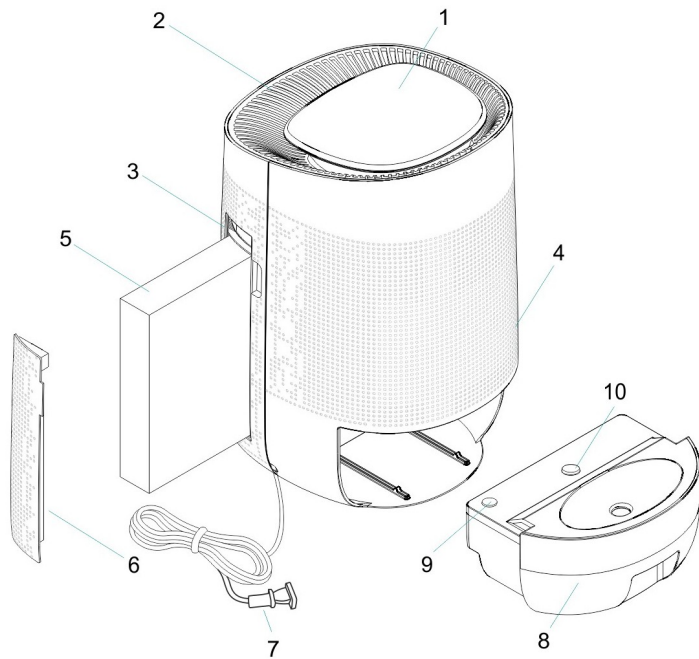

## Control panel

Control panel has 3 buttons and 2 LED indicators.



Purification button



Dehumidification button



Mode button



Power

Power indicator



Water Full

Water full indicator

## Functions

### *Water full instruction*

- When the water tank is full, the machine will be auto-off and its indicator light will change to red and keep flashing.
- Put the water tank back to the machine after pouring the water to restart.

### *Reminder for replacing filter instruction*

- When the machine detects that the filter is out of run, the power indicator will change to orange and keep flashing.
- Press the purification button for 7 seconds to reset after replacing a new filter.

### *Auto-defrost instruction*

- The running temperature for the machine is 5 °C to 50 °C. When the temperature is low, the machine stops dehumidifying, the fan continues running for defrosting.

## Button instructions

After the machine connects with power, the power indicator will turn on.

● Power

### Purification button

- Press the button, the purification indicator will turn on, the machine will start working with air purification.
- Press it again, the machine will power off.



● Air Purifier

### Dehumidification button

- Press this button when the machine is turn on, the machine will dehumidify with purification function.
- Press again, turn off the dehumidification function and its indicator light, the purification function and its indicator will keep operating.



● Dehumidifier

### Mode button

- Press the button to set modes when the function of purification turns on.
- This button can be set two modes circularly: high-grade and low-grade. The corresponding indicator will turn on after setting.



● High ● Low

## Methods of pouring water

1. The water tank has maximum capacity of 1000 ml with 750 ml per day working capacity.
2. The machine will auto-off when the water tank is full, the indicator light will turn on.
3. Please turn off the machine when water tank is full, pull out the water tank, do not tilt the water tank or water will be leaked.
4. Please reset the water tank and restart the machine after pouring the water.
5. Do not move or destroy the water tank float, otherwise the machine will not work or cause any other unnecessary breakdowns.

## Maintenance

1. Ensure the machine is power-off and unplugged before maintenance.
2. Do not immerse the dehumidifier in water or any liquid.
3. Do not use abrasive, corrosive or flammable cleansers (such as bleach or alcohol) to clean any part of the machine.
4. Pour out water if you don't use machine.
5. Please clean up the dust of the filter regularly, it can not be washed or reused.
6. Clean machine with damp cleaning cloth only.

## FAQ

No working	<ul style="list-style-type: none"> <li>• is it plugged into a power socket? is there a power outage?</li> <li>• is the home leakage switch or fuse cut off?</li> <li>• is the water full?</li> </ul>
Poor performance (less water in the tank)	<ul style="list-style-type: none"> <li>• is the filter blocked?</li> <li>• is the door opened?</li> </ul>

	<ul style="list-style-type: none"> <li>• is there any obstacle blocking the air inlet/outlet?</li> <li>• is there any other equipment releasing steam indoor?</li> <li>• is the indoor temperature too low? the dehumidification capacity will be weaken in low temperature and humidity environment</li> </ul>
The air volume becomes smaller	<ul style="list-style-type: none"> <li>• is the filter too dirty so that it blocks the air to enter inside?</li> <li>• is the air inlet/outlet of the machine blocked by something?</li> </ul>
Significant noise	<ul style="list-style-type: none"> <li>• is there anything stuck on the fan in the air outlet?</li> <li>• is the machine tilted?</li> </ul>
Leakage	<ul style="list-style-type: none"> <li>• is the machine tilted or dumped?</li> <li>• is there any water in the tank when moving the machine?</li> <li>• is the floating ball in the water tank fall off?</li> </ul>

If the above FAQ can not solve your problems and need maintenance, please contact the supplier or after sales service center. Please do not disassemble the machine to maintain by yourself.

## Technical specification

Input: AC100-240V 50/60 Hz

Power: 45 W

Size: 195 x 215 x 315 mm

Noise: 45 dB

Working capacity: 750 ml/day (30 °C / 80 %RH)

Water tank capacity: 1000 ml

Suitable for rooms: 10-20 m<sup>2</sup>

Certification: CE, EMC, WEEE

## Disposal of the device (environment)

The European directive 2012 / 19 / CE on Waste Electrical and Electronic Equipment (WEEE), requires that old household electrical appliances must not be disposed in the normal unsorted municipal waste stream. Old appliances must be collected separately in order to optimize the recovery and recycling of the materials they contain and reduce the impact on human health and the environment. The crossed out “wheeled bin” symbol on the product reminds you of your obligation, that when you dispose of the appliance it must be separately collected. Consumers should contact their local authority or retailer for information concerning the correct disposal of their old appliance.



This product is in compliance with the essential requirements and other relevant provisions of EMC directive 2014/30/EU. The device was approved for use in EU countries, therefore, bear the CE. All necessary documentation is available at the importer address.

Changes in technical parameters, properties, printing errors in the instruction manual reserved.

Importer address:

Bibetus s.r.o.

Loosova 262/1

Brno 638 00

Czech republic

E-mail: info@bibetus.cz