

Multifunctional air cleaner and humidifier

Airbi PRIME

Model: AWI-40PTOC

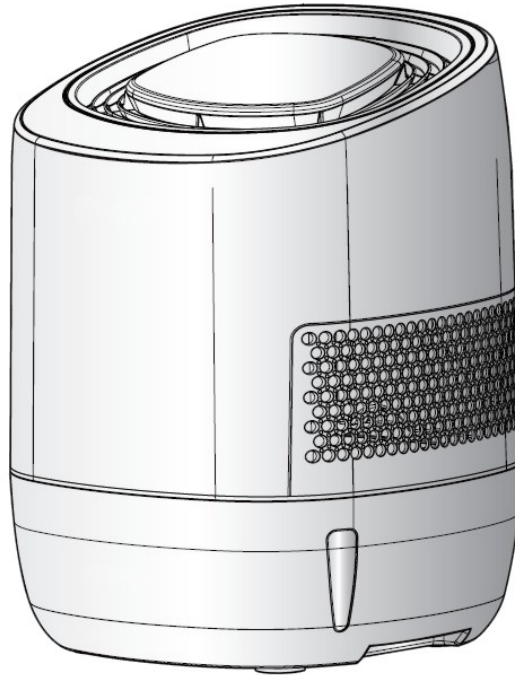

Instruction manual

(version 1.0)



- **Please make sure to read the instruction manual carefully. This information will help you to familiarise yourself with your new device, to learn all of its functions and parts to find out important details about its first use and how to operate it, and to get advice in the event of faults.**
- **Following and respecting the instructions in your manual will prevent damage to your instrument and loss of your statutory rights arising from defects due to incorrect use. We shall not be liable for any damage occurring as a result of non following of these instructions.**
- **Likewise, we take no responsibility for any incorrect readings and for any consequences which may result from them.**
- **Please take particular note of the safety advice!**
- **Please keep this instruction manual for future reference.**

1 Features of Airbi PRIME

The Airbi PRIME is humidifier and also a air cleaner that rapidly intakes dry and contaminated air and turns it into humidified, fresh, clean and healthy air.

Basic features of Airbi PRIME:

- 1** Optimum humidity level is generated by natural evaporation.

Although the humidificaton process is not visible like other humidifiers, the optimum humidity level(40~60%) is automatically generated by natural evaporation. Large water particles that are visible to the eyes are heavy and may aggravate the respiratory organs and hazardous to health.

- 2** Unique disinfection system with the environmental-friendly material, BSS

BSS (Bio Silver Stone), non-chemical material, kills and eliminates various kinds of germs and viruses inside the water tank. (Germ killing by more than 99.99%).

- 3** Very easy for cleaning water tank and refilling water.

The water tank which has a flat surface inside can be separated from the main body(upper unit). It is very convenient for cleaning water tank and refilling water in the tank.Cleaning once a week is enough for maintaining the germ- killing power.

- 4** The air is cleaned without replacing an air purifying filter. The water in the tank washes the air.

The water absorbs not only dusts and bad smells but also formaldehyde which cause atopic dermatitis in a newly built house. Breathe the fresh air from Airbi PRIME and feel the freshness like the moist clean air after the rain.

2 Safety advices



Warning

Criteria for possible critical danger to life or fire if not complied.



Caution

Criteria of possible danger to health or damage to the product if not complied.

2.1 Important criteria before usage



Warning

The product is only for domestic use in 230V 50Hz voltage.

- If voltage other than 110V is used, the product can become defected or fail to function.
- For overseas uses when the voltage is different, it may fail to work or fire may ensue.

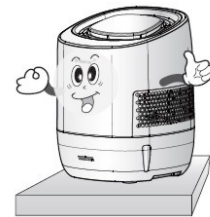

Warning

Please avoid exposure to direct light, places of high heat or near heaters.

- Change of color or form may occur in the exterior of the product.
- If the product is too near a heater, fire may occur.

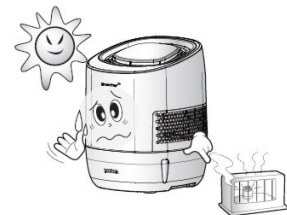

Warning

Please use it on a solid and flat floor

- If the floor is tilted, sound may be created or the internal parts may alter in form.
- Instead of on a table, using it on a floor can be safer.

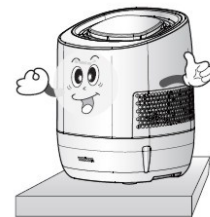

Warning

Do not handle the electrical cord with wet hands.

- If water is contacted, electrocution may occur.

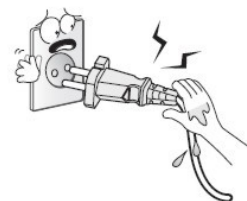

2.2 Important criteria to follow for operation and management



Caution

Do not use too near the wall.

- Since the humidified and clean air is supplied from the front, right and left sides, it should be placed at least 30cm from the walls. (for the back, 10cm space should be allowed)
- Sufficient ventilation is important for the product to function effectively.

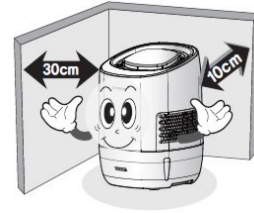

Caution

Don't use it close to other electric housing appliance.

- Keep at least 30cm of distance from them to minimize harmful effect.

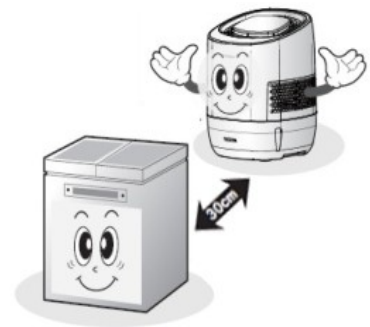

Warning

Do not sit or step on the product.

- The product may be broken and/or cause injury. (Especially be careful of children's behavior).



Warning

If smoke or a burning smell are detected, unplug the product immediately to stop operation and call customer service.

- Danger of product damage, electric shock and fire.



Warning

Please do not use flammable spray near the product

- Danger of fire and the plastic sides may damage.





Caution

Please don't use harmful substance to plastics

- There may be harmful influence (breaking, etc.) to plastic products when perfume products (aroma) is used.
- If you use it near a kitchen, oil components were splashed to damage or contaminate plastic products, so it may be difficult for you to clean the plastic products.

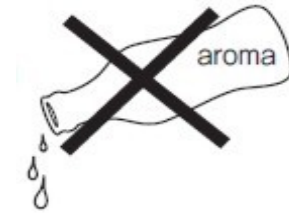

Warning

Please do not pour hot water.

- The product may change form or lead to malfunctioning.
- Use cool or lukewarm water which is under 40°C.



Warning

Do not forcefully enter sticks or fingers into the intake or the exhaust or attempt to independently remodel or separate the product.

- May lead to product malfunction or inflict injuries.
- In case of need, please contact customer service.



Warning

When in operation, do not use clothing, towels or others on top.

- It may lead to heating.
- The top part of the product is for intake of dry and contaminated air.

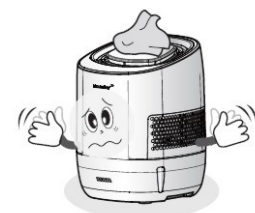

Caution

Do not use the product near the hair.

- When sleeping, do not place it near your head. The evaporation of cold air could cause cold. Place it in distance from your sleeping position.





Caution

Stand the body up while cleaning or supplying water.

- Damage to the product surface may occur if you lay it down.



Caution

Do not handle with force the disinfectant device (BSS) surface

- The content may damage.

Do not separate or eat the disinfectant device or use it for other purpose without consultation.

- The disinfectant material may affect the respiratory organs.



Warning

Do not handle with force the disinfectant device (BSS) surface

- The content may damage.

Do not separate or eat the disinfectant device or use it for other purpose without consultation.

- The disinfectant material may affect the respiratory organs.



Caution

When moving the product, move the upper main part and the lower cistern separately.

- When moving, the internal water may spill.





When not in use for an extensive time, empty out completely the water in the cistern, clean the cistern and the disk and store after drying.

- Otherwise, contamination may occur.
- If not in use for more than two days, empty out the water and turn off the electricity.



In case of power cord damage, please call our service center for appropriate repair.

- Do not disconnect the power connector from the product while the power cord is plugged in the socket.



Clean or supply water after plugging out from the power.

3 Correct Operation

3.1 Installation

After moving to place of installation read the [Safety Advices] first and use if as follows.

After removing the product from the package, remove the packing material and the vinyl like the drawing and then remove the interior tape of the product and the interior packing material.

If operated without removing the inside packaging material, the product does not operate or may be broken.

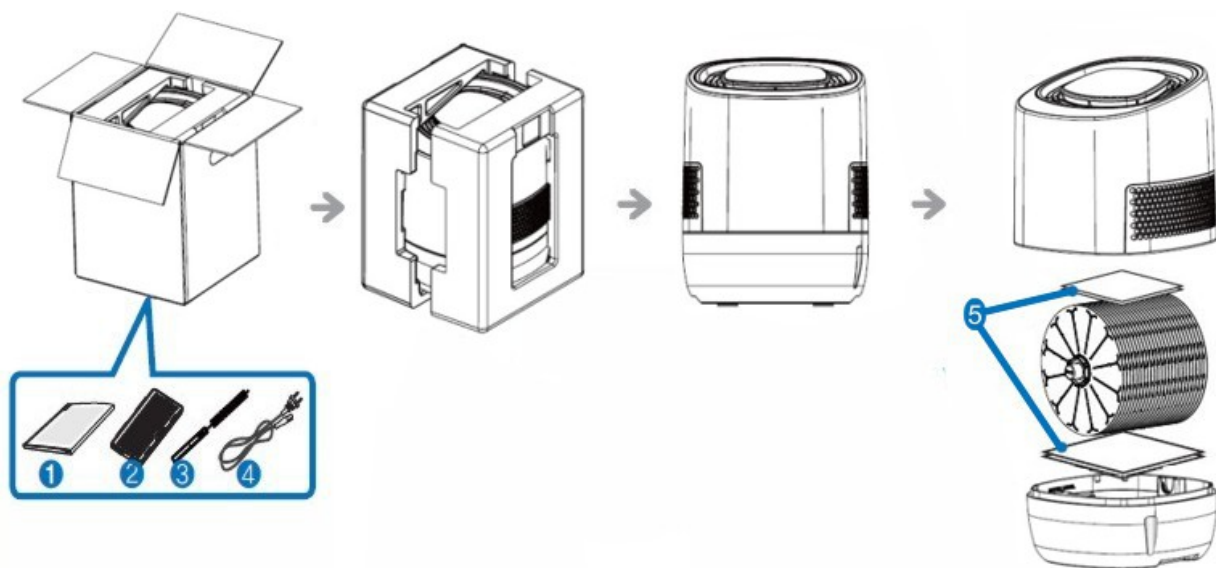

You will find in the box

1. User manual
2. BSS filter

3. Easy kit (brush)
4. Power cord
5. Packaging material

3.2 Product overview

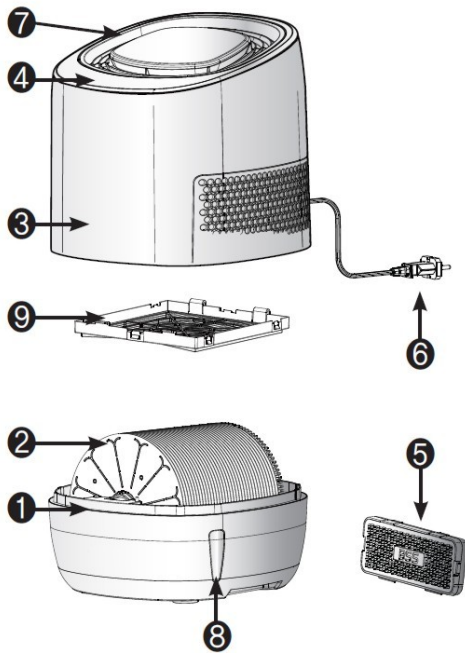

1. **Cistern** - A place to store water for evaporation and air cleaning.
2. **Disk** - The water in the cistern is pumped up and a water film is formed on the surface with the water being evaporated and the minute dirt being eliminated.
3. **Body (Main Frame)** - The fan and motor that control the air flow is located here and clean air is supplied through the exit duct in the left and right side.
4. **Operating panel** - It contains power button and operation mode selection button. Also, it contains the window which shows the operational status.
5. **Disinfectant device (BSS: Bio Silver Stone)** - Placed in the floor of the cistern, it prevents and contamination.
 ※ Although the life cycle of the disinfectant may vary, it should accommodate an operation period of 24 hours a day for about 12 month. (For repurchase of the part, please consult the customer service center.)
6. **Power cord** - Supplies Electricity to the Product.
7. **Upper cover** - The upper side is dried and the contaminated air is taken in.
8. **Water level gauge** - It is possible to see the water level from outside.
9. **Pre-filter** - It eliminates the dust of intake air first.

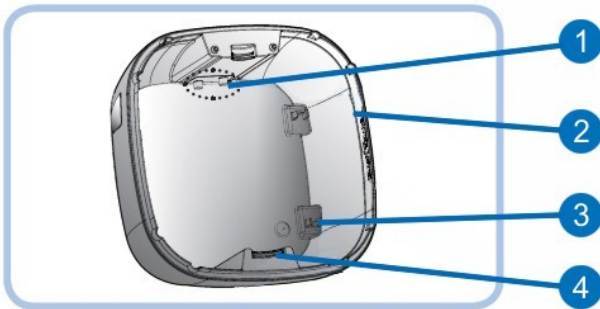

1. **Water sensor** -
 Caution: Please wipe the sensor every week. Water level may not be detected if it is contaminated.
2. **Water level**
 It is marked on each side of inner part of the water tank. Fill water not to exceed the line.

3. **Disinfectant device (fixed part)** - It is located inside of the tank at the bottom right.

4. **Disc fixing part** - Fix it properly on the front and back side of the disc.

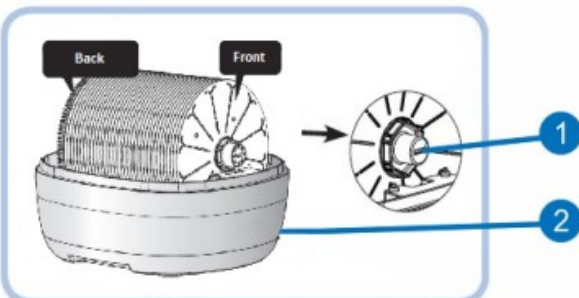

1. **Cap** – The disk is easily separated if you turn it by using a coin in case of disk washing.
2. **Warning:** The side with sticker attached is the front. The product will not operate if the front and back of the tank are changed.

3.3 Operation preparation

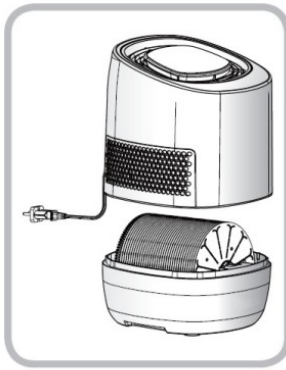

Lift up the upper part of the main frame and place it sidewise.

Remove the insulation for shock absorption in the lower part of the internal disk. (When using for the first time).

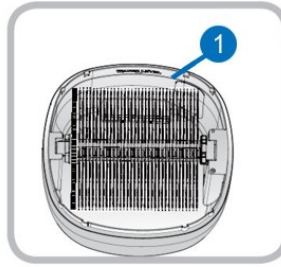

Fill the water no more than water level (1) marked on both sides of the tank. When using underground water, scale (lime) could form on the surface of the disk, cistern and the disinfectant device so please use tap water.

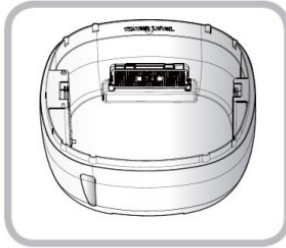

After removing the packing and the vinyl of the disinfectant device (BSS) place it into the floor of the cistern's insert part until you hear a "click" sound.



Return the upper part of the main frame to its original position. Install the cistern and the control switch in the front side.

If the direction is wrong, spacing occurs in between the upper part of the main body and the cistern so operations is not possible.

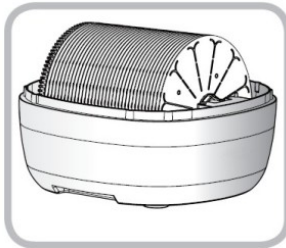

The product will not operate if the front and back of the tank are changed.



Please insert the connector to the product first and then insert the plug to the wall socket.

When disconnecting the power cord, please pull out the plug from the wall socket first and then separate the connector from the product.

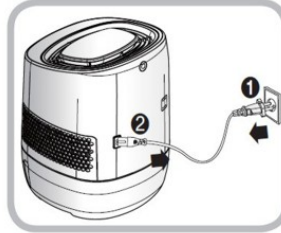

3.4 Operation panel

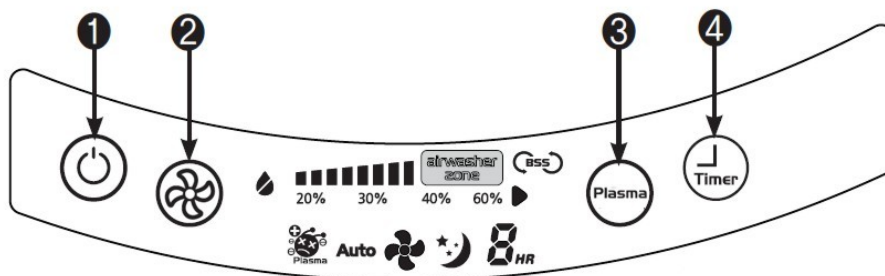

Button 1: Switches the device on/off

Touching this button lightly will switch the device on/off.

Button 2: Changes operation mode

Auto – In this operation mode the device adjusts speed (low, medium, high) depending on surrounding air humidity. The device switches off by itself if humidity higher than 60% is detected and switches on if humidity drops below 60%.

Note: When the device detects humidity higher than 60%, only the humidifier is switched off (the disks stop rotating). The cleaning function of the device is not interrupted and the fan switches to low speed.

Super-wind Operation – The device runs in maximum performance mode regardless of surrounding air humidity. Use when you want to airwash and humidify space the size of a living room.

Strong-wind Operation – The device runs in medium performance mode regardless of surrounding air humidity. Use when you want to airwash and humidify space the size of a regular room.

Weak-wind Operation – The device runs in low performance mode regardless of surrounding air humidity. Use when you want to airwash and humidify a small room.

Sleeping Operation – The device operates quietly. It switches off when surrounding air humidity exceeds 60% and it switches on when it drops below 60%. Display brightness dims by a half so as not to disturb sleep.

Button 3: Switches the plasma ion generator on/off and switches between cleaning/humidifying modes

This button switches plasma ion generator on/off and also switches between cleaning/humidifying modes.

Button 4: Timer is set and switched on

Touching this button lightly you will switch on the timer. You can set 1 – 8 hours.

3.5 Display

The display of the device is back lit to enable operation and setting. The display brightness dims by half after one minute after the last touch on the operation panel.



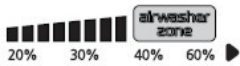

Empty water tank indicator

As soon as there is no water in the water tank, the device switches off and the empty water tank indicator on the operation panel lights up. After refilling the tank, the indicator disappears.



Relative surrounding air humidity

If surrounding air humidity is within 40 – 60%, the  appears on the display. If the humidity is higher than 60%, the  icon appears on the display.

The humidity indicator measures humidity using a built-in humidity sensor inside the device. Therefore this value is more or less accurate depending on ambient temperature, air circulation and the location of the device.

Note: The humidity value stated by the device is just for your information and can differ from other humidity detectors.



BSS Filter Indicator

When the life of the BSS filter expires (approx. 1 year), BSS indicator appears on the operation panel. After replacing the BSS filter, push operation selection button (2) and hold for 3 seconds to reset the BSS filter replacement indicator.



Plasma Ion Generator Indicator

When the plasma ion generation is on, this indicator is also on.



Operation mode indicator

Depending on the selected operation mode, the particular icon switches on on the display.



Timer indicator

Shows the switching off time

To switch off the timer, push button 4 repeatedly until the switching off time disappears.

3.6 Switching on/off and basic operation of the device

When the device is ready to be used, you can start it following these instructions:



Switch it on by pushing Button 1.



Using Button 2 select the operation mode of the device.

The operation mode can be selected in the following order by pushing Button 2 repeatedly.

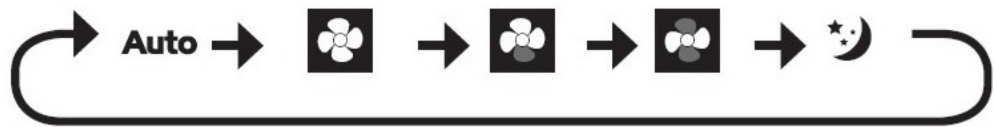

Auto mode: The device selects the fan speed depending on the ambient relative humidity (high, medium or low).

In auto and sleeping modes the fan switches on only when the ambient humidity exceeds 60%.

In sleeping mode the display brightness dims and the display switches off after 10 seconds except switching on/off button and the sleeping mode icon.



If you want to switch the device off, push Button 1.

3.7 Other functions of the device



Plasma system is a unique technology for removing viruses from the air. The viruses are decomposed and then are unable to harm people. This technology is filter independent and uses positive and negative ions which are distributed throughout the and are able to actually kill the viruses.

- Plasma system is active after switching the device on.
- Pushing Button 3 lightly stops humidifying (humidity level indicator disappears from the display). Plasma system is on. To start humidifying again, push the button again.
- To switch off the Plasma system push Button 3 and hold for two second while humidifying is off.



The timer is used for setting the duration of time during which the device should be operating.

- During operation push Button 4.
- The set time can be changed by pushing Button 4 again. The setting follows the order of the modes 1 → 2 → 3 → 4 → 5 → 6 → 7 → 8 → permanent operation (cancelling).

- The set time decreases in one hour steps.
- The device switches off as soon as the set time is reached.
- To switch off the timer, push Button 4 and hold it until the set timing disappears from the display.

3.8 Resupplying of water

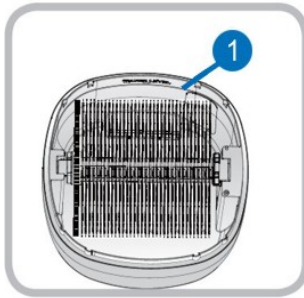

When the empty water tank indicator on the operation panel is on, water must be added to the water tank. Make sure that the water level (1) in the tank does not exceed the maximum water level mark.

Add water for maximum 6 days. The following day the remaining water must be poured out and you should clean the water tank. After that fill the tank with water.

3.9 Emptying of water

If the environment surrounding has excessive dust or odor or frequent ventilation cannot be done, you must empty out the water more frequently.

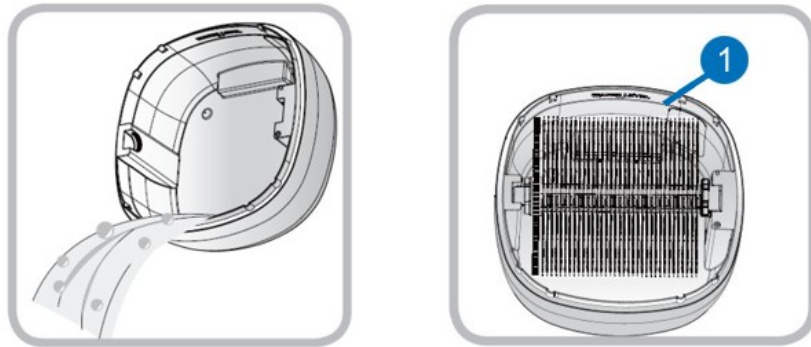

After opening the main body, if the water level (1) of the cistern is at a low level, you must empty out the cistern and resupply with fresh water.

※ The remaining water has dust, foreign material, odor and others so by resupplying with fresh water, the air cleaning function is greatly improved.

Fill the freshwater below the marked water level.

When not in use for more than 2 days, empty out the water. For reuse, resupply the water.

※ For extensive period of disuse, winged insects might enter the interior of the product which might cause the water to smell.

3.10 Cleaning (rotation washing – one time per week)

For cleaning the cistern, disk and the disinfectant device (BSS), they should be done once a week.

※ If much dust or odor are in your surrounding, clean twice a week.

For the upper part of the main body, do not wash with water. The product might malfunction or you might get electrocuted. It should be cleaning by a tightly squeezed wet towel for its interior and exterior. Stop operations and remove the electrical line (power cord) from the socket. Remove the upper part main body.

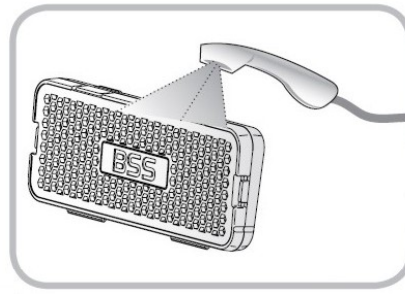
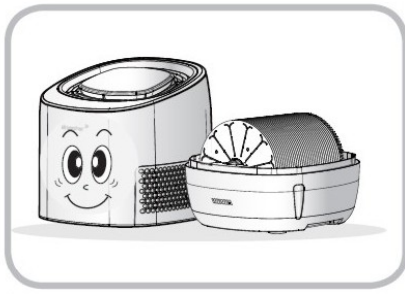

Disinfectant device should be separated from the cistern and washed with a shower for the exterior and the net part.

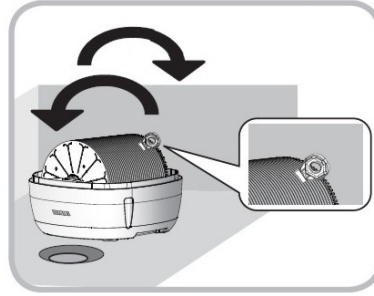
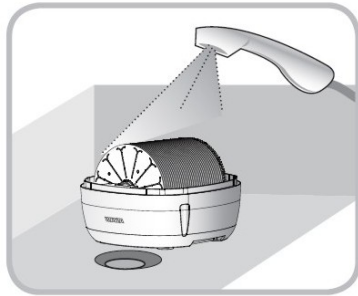

Please fill water in a cistern up to a water level and dissolve proper amount of washing detergent and make foam. Please insert the Easy Kit (brush) in the space between discs and wash it while rotating the discs with hands. If you move the Easy Kit and wash it like brushing, the effects can be enhanced.

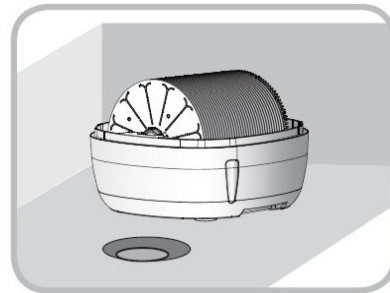
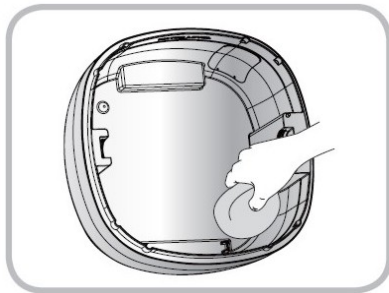

The cistern should be cleaned with a smooth sponge. Clean the water sensor inside the tank. Water level cannot be sensed well if any fur occurs on sensor. The cistern, discs and the disinfectant device should be rinsed cleanly with the disinfectant device placed in its original position in the cistern and after distinguishing the front and back of the discs, they should be lifted on.

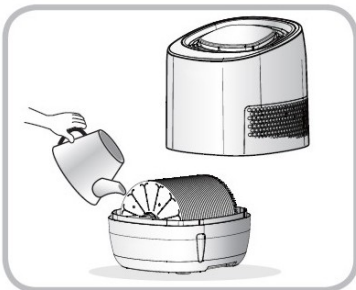

Water should be supplied to the water level of the cistern.

- We recommend to use other container or kettle when refilling water since the tank filled with water is heavy and there is a danger of dropping it.
- The product can smell if it has lot of dust having not cleaned for a while.

Although foreign materials on the cistern and the discs would not make them look good, they do not affect the function of the product. Also, the contaminated foreign materials are not discharged so there is no need to worry.

3.11 Cleaning (separation washing – one time per month)

Separation and cleaning of the disks should be carried out once a month.

(If there are much dust and odor in the surrounding, it should be done twice a month.)

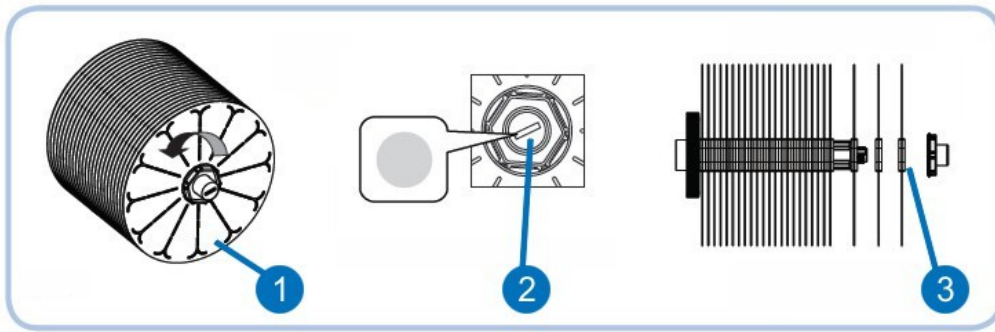

1. Please insert the Easy Kit (brush) into a cap, turn it in an anti-clockwise direction and separate it after opening the cap.
2. When there is not the Easy Kit (brush), please insert a coin into the front of the cap and open it after turning it in an anticlockwise direction.
3. By pushing from the front side consecutively, it is easily separable in whole.

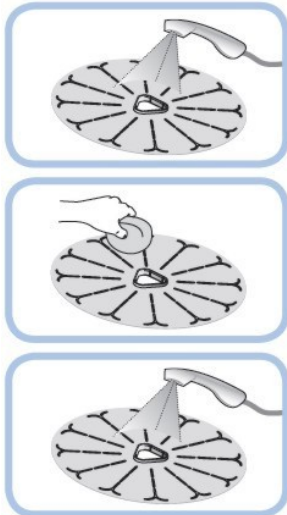

Cleaning the Disc Set

Preparation cleaning by water using shower.

Scrub the front and back of the disc with laundry brush or scrubber using laundry detergent. (If too much scale occurs, use scale remover.)

After cleaning, rinse with shower water again.

Assembly Order : Axis → Gear disc → Discs → Gear disk → Cap

Turn cap clockwise until the disc fasten and does not move. If you use the Easy Kit(Brush), you can tighten the cap easily.

3.12 Cleaning (pre filter – once a month)

The pre filter should be cleaned at least once a month. If the surroundings are polluted, it is necessary to do it more often.



Remove the upper part of the device and place aside.

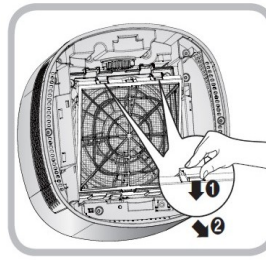

Push the filter holder down and pull the filter towards yourself.

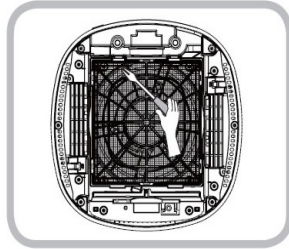

Release the filter screw by a cross screw driver.

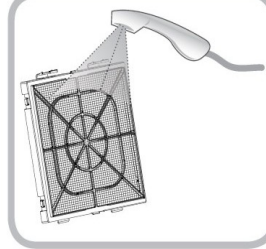

Rinse the filter and clean it with a brush and a detergent. Rinse again and let dry completely.

Return the filter back to its place.

3.13 Cleaning (fan area)

Fan area is necessary to clean whenever it is dirty. Always make sure the device is unplugged from the mains before cleaning. Cleaning the fan area and air-suction is recommended once a year. If the surroundings are polluted, cleaning should be done more often.



Remove the upper part of the device and place aside.

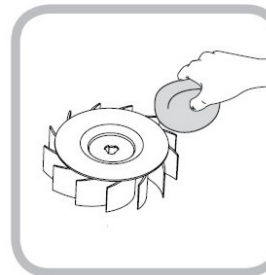

Clean the fan with a sponge soaked in a detergent and then rinse it with a shower.

Let it dry completely.



With a cross screw driver release the fan cover and open it.

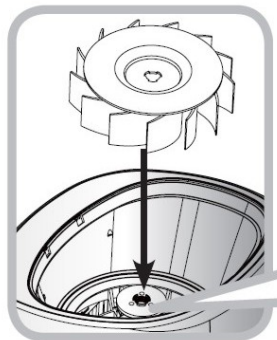

Return the fan.

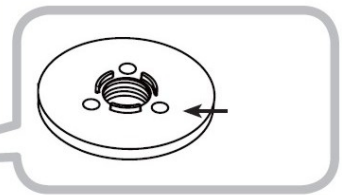

Unlock the fan by releasing the filter lock cap by turning clockwise.

3.14 Cleaning (Plasma ion generator)

The plasma ion generator should be cleaned while cleaning the fan. If the surroundings are polluted, it should be cleaned more often. Always make sure the device is unplugged from the mains before cleaning.

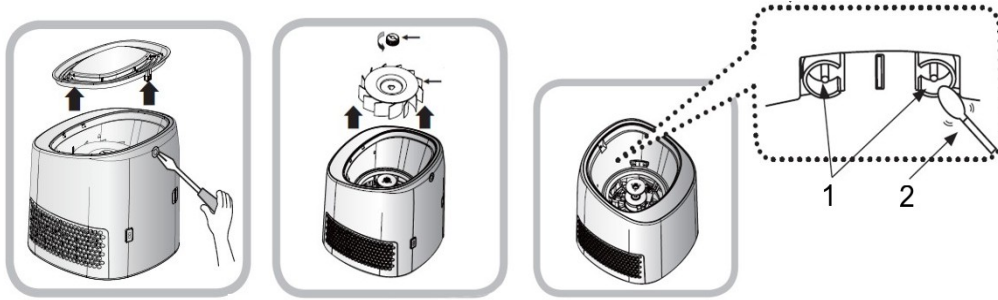

Remove the upper part of the device. With a cross screw driver release the fan cover and open it. Unlock the fan by releasing the filter lock cap by turning clockwise. Carefully remove the dust from the electrode ends (1) with a cotton applicator (2). If it is difficult to remove dust from the electrode ends, you can moisten the cotton applicator but in this case it is vital to dry the electrode with dry cotton wool.

Caution

1. If it is hard to wipe the spot on the lense, clean the lense with a light wet cotton swab. Then wipe the lense with a dry cotton swab.
2. Do not clean with thinner, benzene or alcohol. It might occur the lense's damage.
3. After cleaning, reassemble the fan to its original position.

4 Troubleshooting and fixing problems

Criteria to check before requesting for service.

Condition	Criteria check
Strange sound	<ol style="list-style-type: none"> 1) Are you operating it on a flat surface and not on a decline? <ul style="list-style-type: none"> • Designate a flat surface and move it to that location. 2) Are there articles that block the flow of air around the product? <ul style="list-style-type: none"> • Remove the article that obstructs the operation around the product. 3) Have you assembled the upper part and the lower part cistern without unnecessary space? <ul style="list-style-type: none"> • Match the front part of the cistern lower part with the front part of the upper part main body (console)
Fan does not turn	<ol style="list-style-type: none"> 1) Does the direction of the upper part main body and the lower part cistern match? <ul style="list-style-type: none"> • Match the frontside of the lower part cistern with the upper part of main body frontside (console) 2) Are there any holes between upper part main body and the lower part cistern? <ul style="list-style-type: none"> • The upper part main body and the lower part cistern have to be adjacent without any holes in order to operate properly. 3) Do you see the 'out-of-water' sign? <ul style="list-style-type: none"> • If the water goes below the minimum line, the operation stops. • The operation starts again if you supply water. 4) Are there any sticks or foreign materials stuck around the fan area? <ul style="list-style-type: none"> • Due to carelessness, if there are any foreign materials stuck around the fan area, remove them. 5) In sleeping mode, the fan stops if the room humidity exceeds 60%. 6) Haven't you pressed stop button? Please press the power button on the left.
Disks do not turn	<ol style="list-style-type: none"> 1) For the upper part of the main frame and the lower part of the cistern do the direction match and are they placed correctly? <ul style="list-style-type: none"> • Match the upper part main body frontside (console) with the lower part cistern frontside.

	<p>2) For inside the product, are the disks placed in its correct location and direction?</p> <ul style="list-style-type: none"> Please adjust the disc to be set into its original place. <p>3) Is the cap for the disk assembly loose?</p> <ul style="list-style-type: none"> Please turn the cap clockwise to fasten it. <p>4) In automated/sleeping mode, the fan stops if the room humidity exceeds 60%.</p> <p>5) Haven't you stopped the operation?</p> <ul style="list-style-type: none"> Please press the power button on the left.
--	---

Frequently asked questions.

Main inquiry	Content
The water level does not decrease	<p>1) According to the seasons, the surrounding moisture conditions, temperature and others, the evaporation amount can differ.</p> <ul style="list-style-type: none"> For summer, area of high moisture or low temperature, the evaporation of the water decreases. <p>2) The product does not function properly.</p> <ul style="list-style-type: none"> For [the fan does not turn] and [the disks do not turn] please follow the recommended measures.
Is it really humidifying?	<ul style="list-style-type: none"> The airwasher is a natural evaporating humidifier. Unlike the general humidifier, which forces the water to atomize using the ultrasonic-wave method or the multiple method product, you cannot see the results. You might not feel the humidifying effect of the airwasher for first several days of using it. This is because the surrounding environment like furniture, bed, floor, or wallpaper absorbs the moisture. You may start to feel the optimally humidified environment after a week. Please check the humidifying ability through the water decrement.
Is the humidifying effect good?	<ul style="list-style-type: none"> It has better humidifying ability that ultrasonic or heating humidifier since it reaches fast to optimal humidity level. Also, unlike the atomizing process of the ultra-sonic method, the area around the humidifier does not become damp.
Can you breath comfortably?	<ul style="list-style-type: none"> Due to the atomizing condition of the ultra-sonic method, the water particles makes breathing difficult. For the natural humidifying method, even if the moisture rises, there is no discomfort for breathing due to the natural status of the moisture maintaining method.
Does the air become purified?	<ul style="list-style-type: none"> For much of the odor of the air, it can easily dissolve by alcohol in the water. The airwasher, which uses water as a pure filter, helps to eliminate toxic gases.
How often do I have to resupply water in the cistern?	<ul style="list-style-type: none"> Supply water below the water level mark as you see the 'out-of-water' display. (once a day or two days). The water resupply differs with the surrounding moisture, temperature and situation.
Can the water in the cistern become disinfected?	<ul style="list-style-type: none"> By the disinfectant device (BSS: Bio Silver Stone), more than 99.9% can be disinfected so there is no need for any worry. But, please be sure to wash surely one time a week.
The color of the disinfectant device has changed!	<ul style="list-style-type: none"> This is due to the silver ionization of oxygen in the disinfectant device (BSS) and it will have no effect on the function whatsoever.
Does the contaminated water evaporate?	<ul style="list-style-type: none"> Even if the water of the cistern is contaminated by the dust or foreign materials, only pure water is humidified so there is not need for any worry.
I found the (%) display	<ul style="list-style-type: none"> Most of the case, it is due to temporary error in sensing interior humidity. Try to unplug the power cord for 10 seconds and reconnect it. If the problem

blinking.	persists, please call our customer service.
Can I add perfume (aroma) products?	<ul style="list-style-type: none"> As a phenomenon damaging or breaking the surface can occur by reacting with plastic products, please don't use it.
It smells.	<ul style="list-style-type: none"> When dust and smell are severe according to a use environment and it is not washed more than one time per week (especially a rainy period), smell can be generated. If you dissolve proper amount of Lux or a washing agent to water and wash it, the smell is removed

As a defect is not considered following:

- Device works quietly but not completely silent. Noise less than 35 dB is normal.
- Humidity sensor works just as indicator. It means that ambient humidity can be different up to +/- 10%.

Caution! If your device fails to work despite these tips, please contact the supplier from whom you purchased it.

5 Technical specification

Description	Multifunctional Airwasher and Humidifier
Model	AWI-40PTOC
Electricity consumption	15 W
Max. humidifying capacity	300-450 ml/h
Cistern capacity	156 m ³ /hod
Product size	7 l
Product weight	330 x 330 x 405 mm
Voltage, frequency	6 kg
Fan speeds	220-240 V, 50/60 Hz
Noise	high / medium / low
Warranty	36 db / 30 db / 25 db

6 Waste disposal



This product has been manufactured using high-grade materials and components which can be recycled and reused.



The European directive 2012 / 19 / CE on Waste Electrical and Electronic Equipment (WEEE), requires that old household electrical appliances must not be disposed in the normal unsorted municipal waste stream. Old appliances must be collected separately in order to optimize the recovery and recycling of the materials they contain and reduce the impact on human health and the environment. The crossed out "wheeled bin" symbol on the product reminds you of your obligation, that when you dispose of the appliance it must be separately collected. Consumers should contact their local authority or retailer for information concerning the correct disposal of their old appliance.

All rights for any technical modifications are reserved

EU importer
Bibetus s.r.o.
Loosova 262/1, Brno 638 00, Czech republic
info@bibetus.cz