

Multifunctional air cleaner and humidifier

Airbi MAXIMUM

Model: AWX-70PTOC(CZ)

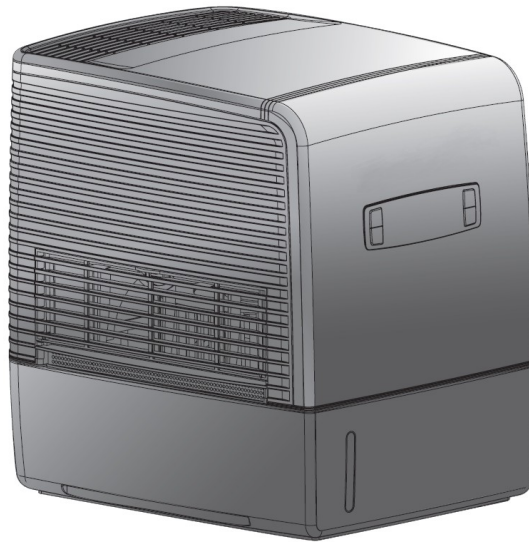

Instruction manual

(version 1.0)



- **Please make sure to read the instruction manual carefully. This information will help you to familiarise yourself with your new device, to learn all of its functions and parts to find out important details about its first use and how to operate it, and to get advice in the event of faults.**
- **Following and respecting the instructions in your manual will prevent damage to your instrument and loss of your statutory rights arising from defects due to incorrect use. We shall not be liable for any damage occurring as a result of non following of these instructions.**
- **Likewise, we take no responsibility for any incorrect readings and for any consequences which may result from them.**
- **Please take particular note of the safety advice!**
- **Please keep this instruction manual for future reference.**

1 Features of Airbi MAXIMUM

The Airbi MAXIMUM is humidifier and also a air cleaner that rapidly intakes dry and contaminated air and turns it into humidified, fresh, clean and healthy air.

Basic features of Airbi MAXIMUM:

1

Optimum humidity level is generated by natural evaporation.

Although the humidificaton process is not visible like other humidifiers, the optimum humidity level(40~60%) is automatically generated by natural evaporation. Large water particles that are visible to the eyes are heavy and may aggravate the respiratory organs and hazardous to health.

2

Unique disinfection system with the environmental-friendly material, BSS

BSS (Bio Silver Stone), non-chemical material, kills and eliminates various kinds of germs and viruses inside the water tank. (Germ killing by more than 99.99%).

3

Very easy for cleaning water tank and refilling water.

The water tank which has a flat surface inside can be separated from the main body(upper unit). It is very convenient for cleaning water tank and refilling water in the tank.Cleaning once a week is enough for maintaining the germ- killing power.

4

The air is cleaned without replacing an air purifying filter. The water in the tank washes the air.

The water absorbs not only dusts and bad smells but also formaldehyde which cause atopic dermatitis in a newly built house. Breathe the fresh air from Airbi MAXIMUM and feel the freshness like the moist clean air after the rain.

2 Safety advices



Criteria for possible critical danger to life or fire if not complied.

Criteria of possible danger to health or damage to the product if not complied.

2.1 Important criteria before usage



The product is only for domestic use in 230V 50Hz voltage.

- If voltage other than 110V is used, the product can become defected or fail to function.
- For overseas uses when the voltage is different, it may fail to work or fire may ensue.

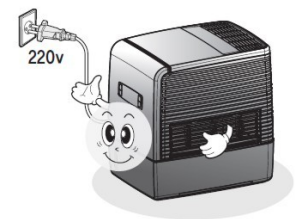

Please avoid exposure to direct light, places of high heat or near heaters.

- Change of color or form may occur in the exterior of the product.
- If the product is too near a heater, fire may occur.

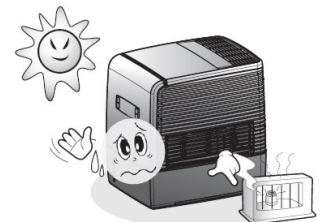

Please use it on a solid and flat floor

- If the floor is tilted, sound may be created or the internal parts may alter in form.
- Instead of on a table, using it on a floor can be safer.

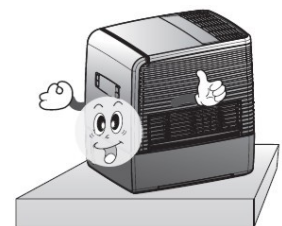

Do not handle the electrical cord with wet hands.

- If water is contacted, electrocution may occur.

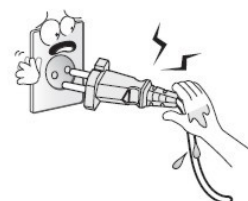

2.2 Important criteria to follow for operation and management



Caution

Do not use too near the wall.

- Since the humidified and clean air is supplied from the front, right and left sides, it should be placed at least 30cm from the walls. (for the back, 10cm space should be allowed)
- Sufficient ventilation is important for the product to function effectively.

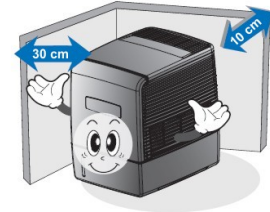

Caution

Don't use it close to other electric housing appliance.

- Keep at least 30cm of distance from them to minimize harmful effect.

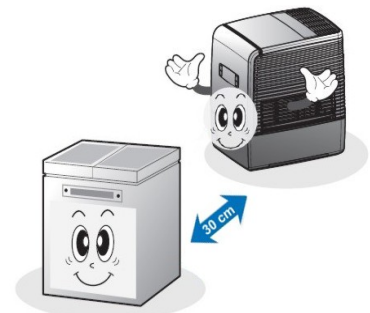

Warning

Do not sit or step on the product.

- The product may be broken and/or cause injury. (Especially be careful of children's behavior).



Warning

If smoke or a burning smell are detected, unplug the product immediately to stop operation and call customer service.

- Danger of product damage, electric shock and fire.

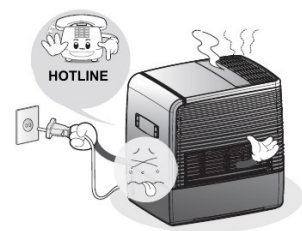

Warning

Please do not use flammable spray near the product

- Danger of fire and the plastic sides may damage.

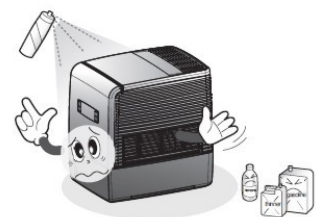



Caution

Please don't use harmful substance to plastics

- There may be harmful influence(breaking, etc.) to plastic products when perfume products(aroma) is used.
- If you use it near a kitchen, oil components were splashed to damage or contaminate plastic products, so it may be difficult for you to clean the plastic products.

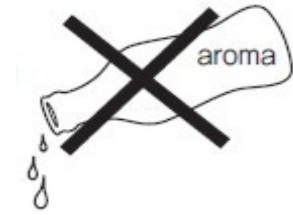

Warning

Please do not pour hot water.

- The product may change form or lead to malfunctioning.
- Use cool or lukewarm water which is under 40°C.

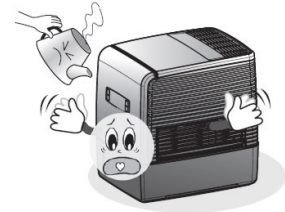

Warning

Do not forcefully enter sticks or fingers into the intake or the exhaust or attempt to independently remodel or separate the product.

- May lead to product malfunction or inflict injuries.
- In case of need, please contact customer service.

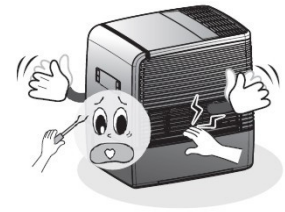

Warning

When in operation, do not use clothing, towels or others on top.

- It may lead to heating.
- The top part of the product is for intake of dry and contaminated air.

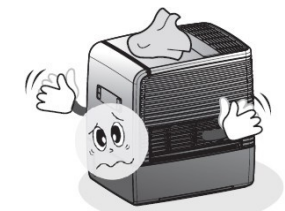

Caution

Do not use the product near the hair.

- When sleeping, do not place it near your head. The evaporation of cold air could cause cold. Place it in distance from your sleeping position.

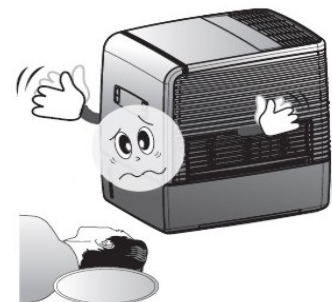



Caution

Stand the body up while cleaning or supplying water.

- Damage to the product surface may occur if you lay it down.

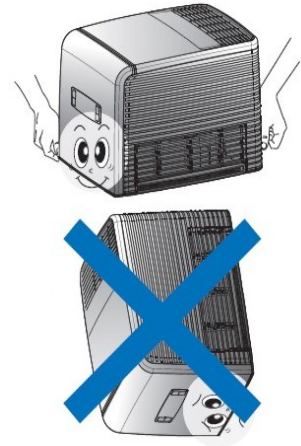

Caution

Do not handle with force the disinfectant device (BSS) surface. The content may damage.

Do not separate or eat the disinfectant device or use it for other purpose without consultation.

- The disinfectant material may affect the respiratory organs.

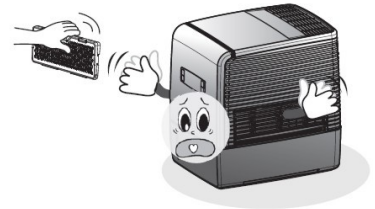

Warning

Do not handle with force the disinfectant device (BSS) surface. The content may damage.

Do not separate or eat the disinfectant device or use it for other purpose without consultation.

- The disinfectant material may affect the respiratory organs.

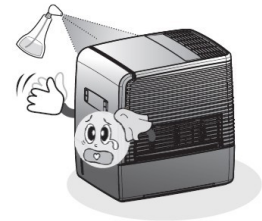

Caution

When moving the product, move the upper main part and the lower cistern separately.

- When moving, the internal water may spill.

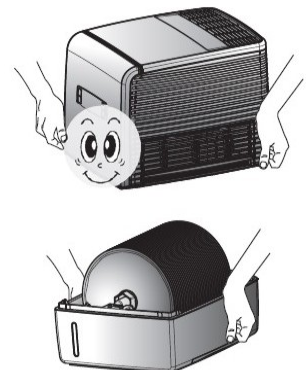

Caution

When not in use for an extensive time, empty out completely the water in the cistern, clean the cistern and the disk and store after drying.

- Otherwise, contamination may occur.
- If not in use for more than two days, empty out the water and turn off the electricity.



Warning

In case of power cord damage, please call our service center for appropriate repair.

- Do not disconnect the power connector from the product while the power cord is plugged in the socket.



Caution

Clean or supply water after plugging out from the power.

3 Correct Operation

3.1 Installation method

After moving to place of installation read the [Safety Advices] first and use if as follows.

After removing the product from the package, remove the packing material and the vinyl like the drawing and then remove the interior tape of the product and the interior packing material.

If operated without removing the inside packaging material, the product does not operate or may be broken.

You will find in the box

1. User manual
2. BSS filter
3. Easy kit (brush)
4. Packaging material

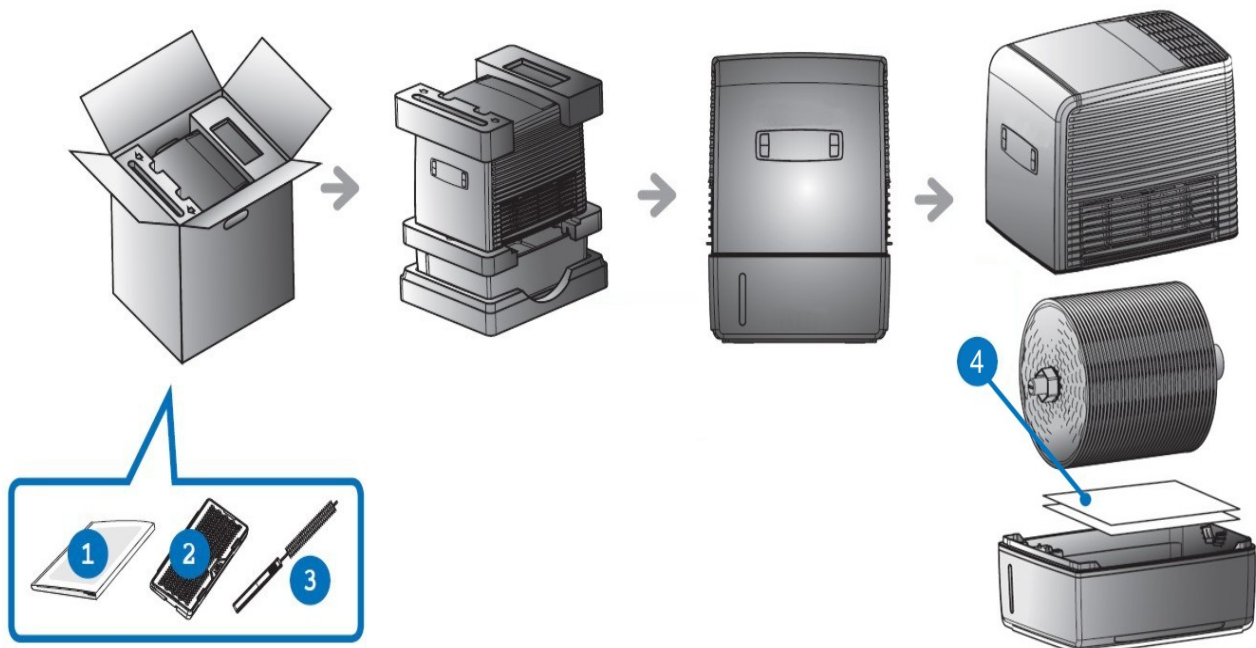

3.2 Product overview

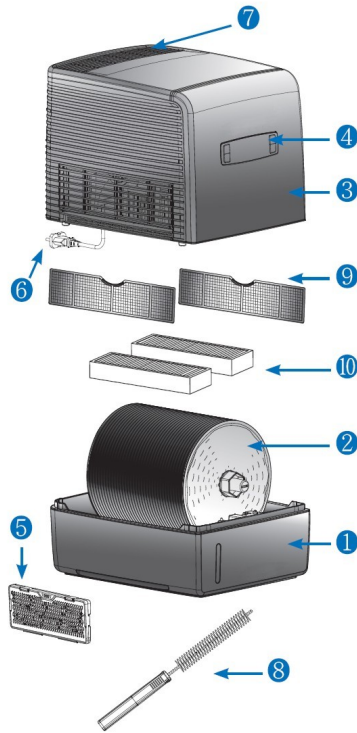

1. **Cistern** - A place to store water for evaporation and air cleaning.
2. **Disk** - The water in the cistern is pumped up and a water film is formed on the surface with the water being evaporated and the minute dirt being eliminated.
3. **Body (Main Frame)** - The fan and motor that control the air flow is located here and clean air is supplied through the exit duct in the left and right side.
4. **Operating panel** - It contains power button and operation mode selection button. Also, it contains the window which shows the operational status.
5. **Disinfectant device (BSS: Bio Silver Stone)** - Placed in the floor of the cistern, it prevents and contamination.
※Although the life cycle of the disinfectant may vary, it should accommodate an operation period of 24 hours a day for about 12 month. (For repurchase of the part, please consult the customer service center.)
6. **Power cord** - Supplies Electricity to the Product.
7. **Upper cover** - The upper side is dried and the contaminated air is taken in.
8. **Easy kit (Brush)** – You can clean disks without disassembling and fasten/loosen the cap.
9. **HEPA-filter** – If you operates on Quick airwasher mode when the air has been too polluted, you can purify the contaminated air through the HEPA filter.

3.3 Operating panel and display Window

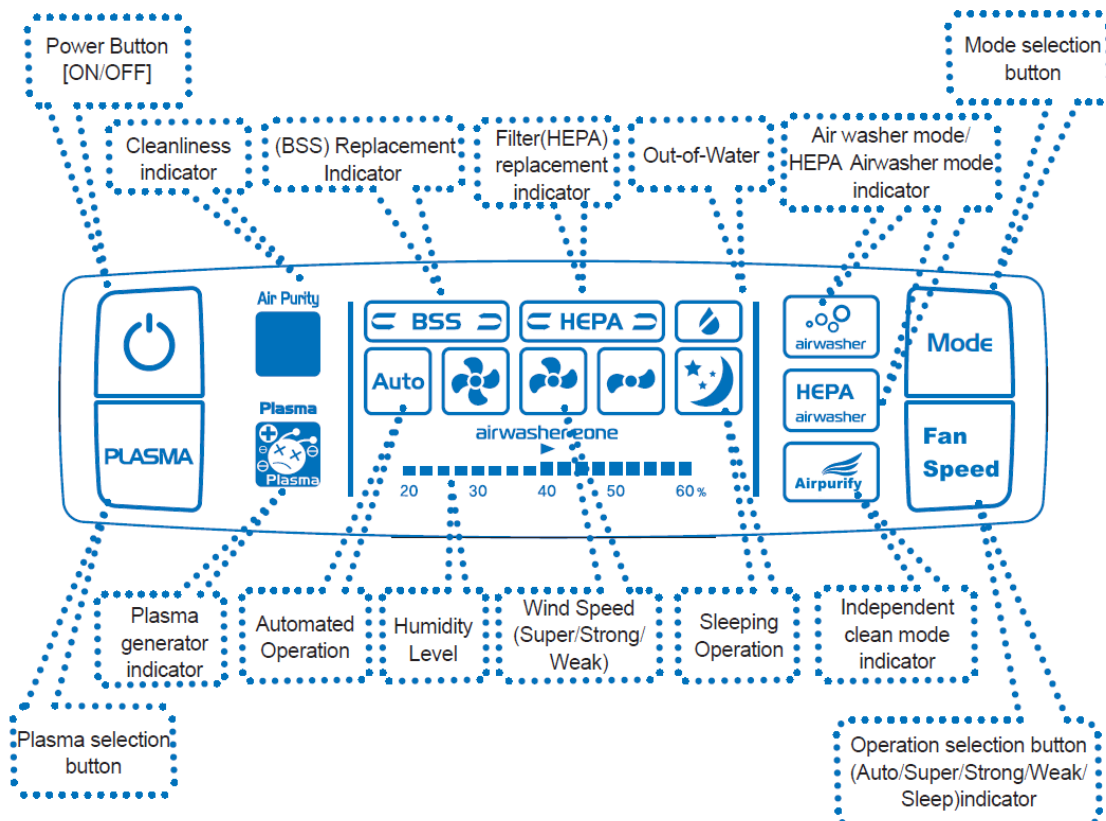

*Airwasher zone lamp is indicated when the humidity level is between 40~60%)

Replacing Disinfectant Device (BSS)

1. If BSS replacement indicator lights up
2. Purchase new BSS from customer service center or any of our agencies.
3. Insert new BSS into socket located in the water tank.
4. Press 'BSS Reset' button with thin object for 3 seconds to turn the light off.

3.4 Water tank

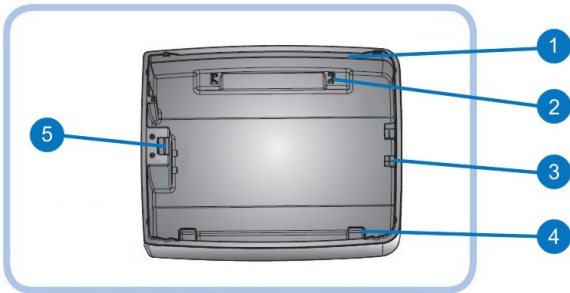

5. **Water sensor** - Caution: Please wipe the sensor every week. Water level may not be detected if it is contaminated.

1. **Water level** - It is marked on each side of inner part of the water tank. Fill water not to exceed the line.
2. **BSS socket** - It is located inside of the tank at the bottom right.
3. **Disc Fixing Part** - Place disc properly on the grooves at front and back side of the tank.
4. **Cleaning Kit (Brush) hanger part**

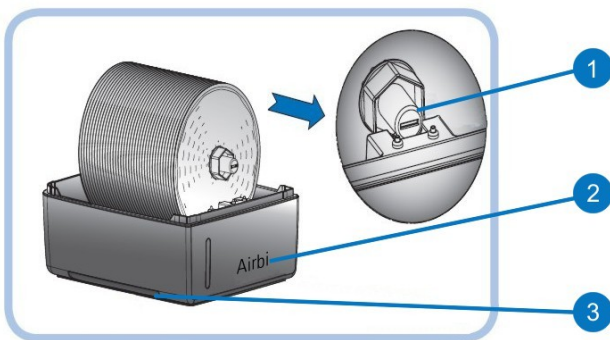

1. **Cap** - The disk is easily separated if you turn it by using a coin in case of disk washing.
2. **Warning:** The side with sticker attached is the front. The product will not operate if the front and back of the tank are changed.
3. **Handle (both sides)** - For use when moving the product or lifting conveniently

3.5 Preparing for use



Lift up the upper part of the main frame and place it sidewise.

Remove the insulation for shock absorption in the lower part of the internal disk. (When using for the first time).

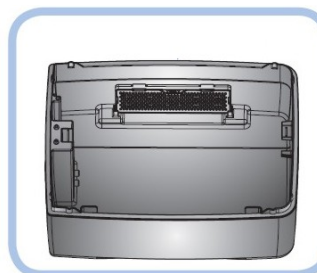

After removing the packing and the vinyl of the disinfectant device (BSS) place it into the floor of the cistern's insert part until you hear a "click" sound.

Make the side with sticker to see the front.

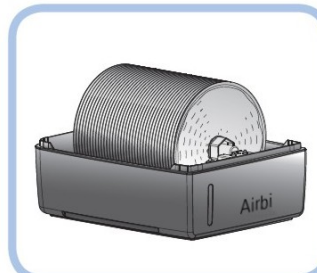

The product will not operate if the front and back of the tank are changed.



Fill the water no more than water level (1) marked on both sides of the tank. When using underground water, scale (lime) could form on the surface of the disk, cistern and the disinfectant device so please use tap water.

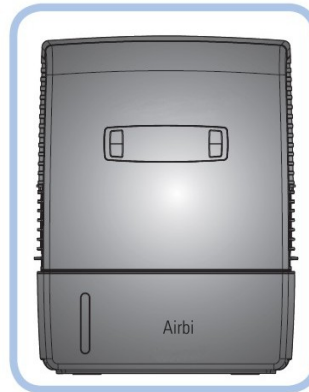

Return the upper part to its original position. If the direction is wrong, spacing occurs in between the upper part of the main body and the cistern so operations is not possible.

Insert plug into the wall socket.

3.6 Power on/off and operation

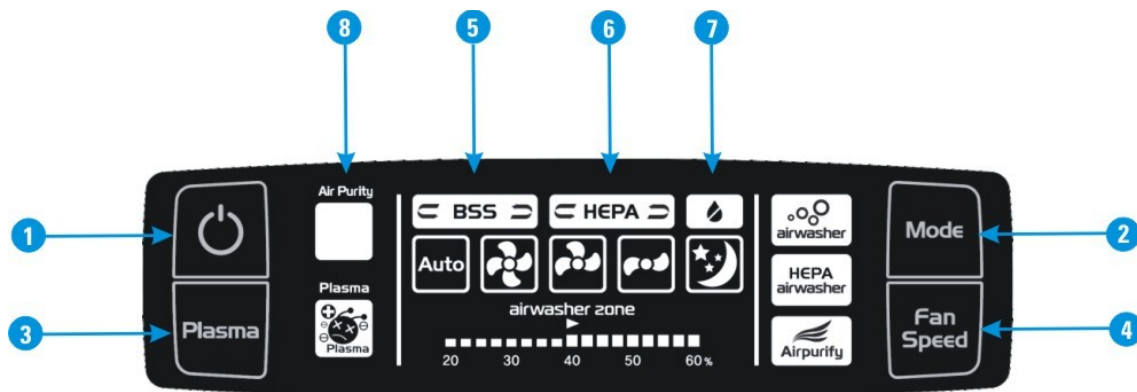

Button 1: power on/off

When you press the button, the product will start or stop its operation.

Button 2: Operation mode selection

You can select between operation modes – only humidifying (airwasher), cleaning and humidifying (HEPA airwasher) or just only cleaning (Air purify).

Button 3: power on/off plasma function



When you press the button the plasma generator will start or stop its operation.

Button 4: changes wind speed



Auto – According to surrounding humidity level, fan speed runs in 3 mode: super, strong, weak. It will run in weak fan speed if the humidity level reaches 60%



Super-wind – Regardless of the surrounding humidity level, fan runs at maximum speed. You can use for large space's humidifying or purifying.



Strong-wind – Regardless of the surrounding humidity level, fan runs at medium speed. You can use for medium space's humidifying or purifying.



Weak-wind – Regardless of the surrounding humidity level, fan runs at weak speed. You can use for small space's humidifying or purifying.



Sleep-mode – Running in quiet mode, fan will run in weak speed when humidity level reaches 60%. And dimmer function will activate to half of normal light.

Indicator 5: BSS replacement



When BSS runs out (approx. 1 year) the light will turn on. After replacing BSS, press the Power button and Plasma button simultaneously for 3 seconds. Then the light will turn off.

Indicator 6: HEPA filter replacement



When HEPA filters run out (approx. 1-2 years), the light will turn on. After replacing HEPA filters, press Mode button and Fan speed button simultaneously for 3 seconds. Then the light will turn off.

Indicator 7: Water tank empty



When the water runs out, the product stops operating and the light will turn on. Operate after refilling with water.

Indicator 8: Cleanliness



It indicates the cleanliness of the ambient air

- Blue light: high level of cleanliness
- Yellow light: middle level of cleanliness
- Red light: low level of cleanliness

3.7 Refilling of water



When the empty water tank indicator on the operation panel is on, water must be added to the water tank. Make sure that the water level (1) in the tank does not exceed the maximum water level mark.

Add water for maximum 6 days. The following day the remaining water must be poured out and you should clean the water tank. After that fill the tank with water.

3.8 Emptying of water

If the environment surrounding has excessive dust or odor or frequent ventilation cannot be done, you must empty out the water more frequently.



After opening the main body, if the water level (1) of the cistern is at a low level, you must empty out the

cistern and resupply with fresh water.

※ The remaining water has dust, foreign material, odor and others so by resupplying with fresh water, the air cleaning function is greatly improved.

Fill the freshwater below the marked water level.

When not in use for more than 2 days, empty out the water. For reuse, resupply the water.

※ For extensive period of disuse, winged insects might enter the interior of the product which might cause the water to smell.

3.9 Replacing of HEPA filter

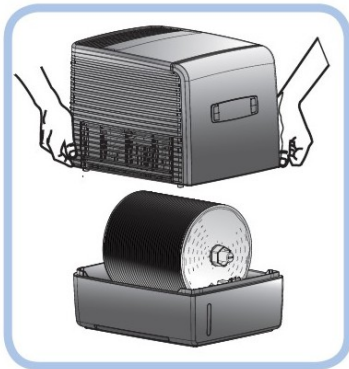

If the HEPA filters are polluted heavily, replace as instructed below.

Caution: Be sure to unplug the product before replacing

Lift up the upper body from water tank and put it down on the floor.

Turn the body over and broaden filter fixer side to side. Then haul at a tag and pick out the hepa filter.

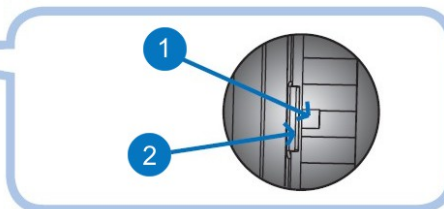
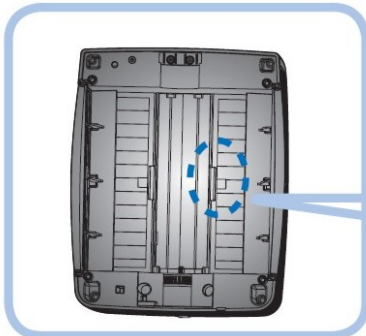

1 – tag for separating

2 – filter fixer

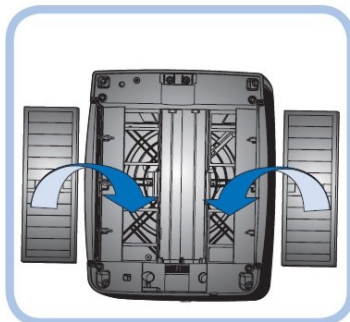

You can assemble the new filter in reverse order of separating.

When replacing the filter be careful not to change the front and rear side of filters.

3.10 Cleaning (rotation washing – one time per week)

For cleaning the cistern, disk and the disinfectant device (BSS), they should be done once a week.

※ If much dust or odor are in your surrounding, clean twice a week.

For the upper part of the main body, do not wash with water. The product might malfunction or you might get electrocuted. It should be cleaned by a tightly squeezed wet towel for its interior and exterior. Stop operations and remove power cord from the socket. Remove the upper part main body.

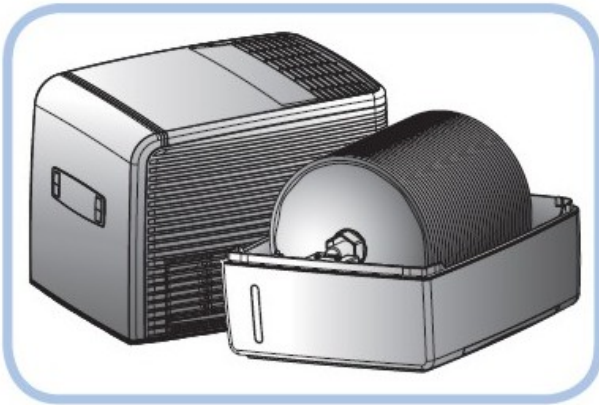

Place down the upper body on an upright position

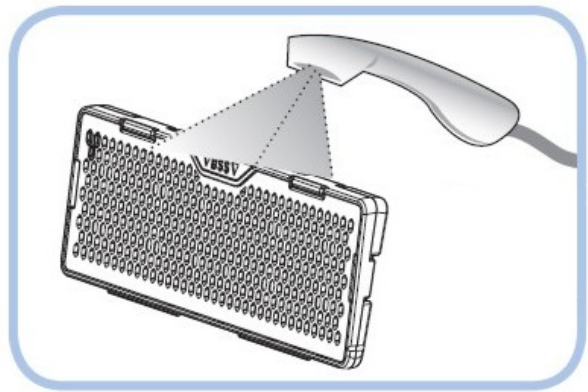

After taking BSS out of the tank, wash it with detergent and rinse it with fresh water.

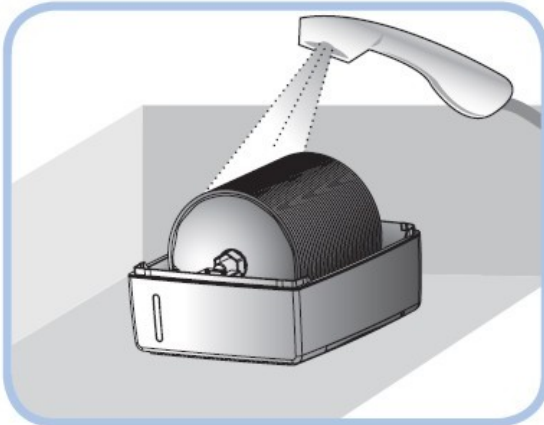

Please fill water in the tank up to the water level and dissolve proper amount of washing detergent and make foam.

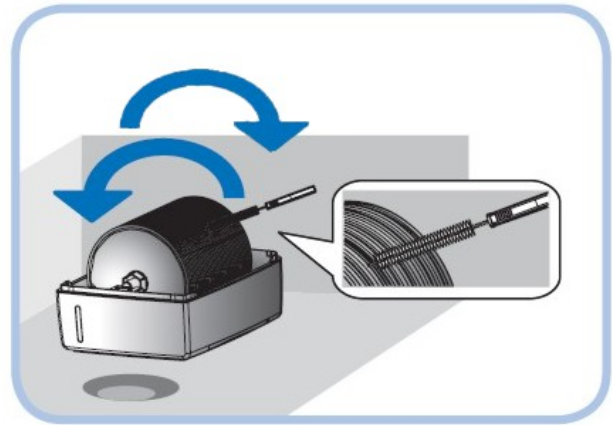

Please insert the Easy Kit (Brush) in the space between discs and wash it while rotating the discs with hands. If you move the Easy Kit and wash it like brushing, the effects can be enhanced.

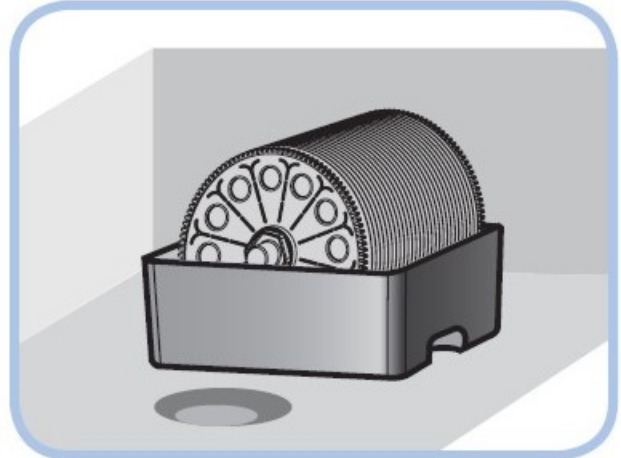
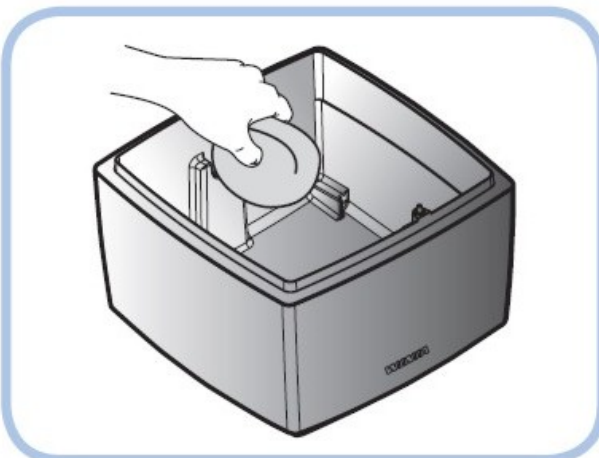

The cistern should be cleaned with a smooth sponge. Clean the water sensor inside the tank. Water level cannot be sensed well if any fur occurs on sensor. The cistern, discs and the disinfectant device should be rinsed cleanly with the disinfectant device placed in its original position in the cistern and after distinguishing the front and back of the discs, they should be lifted on.

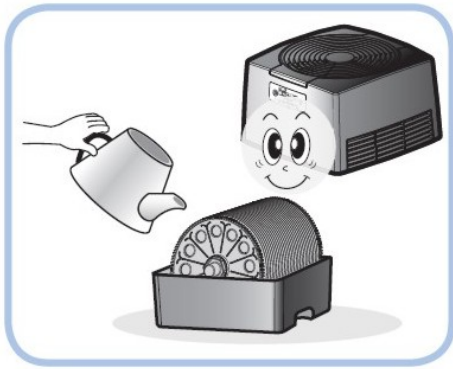

Water should be supplied to the water level of the cistern.

- We recommend to use other container or kettle when refilling water since the tank filled with water is heavy and there is a danger of dropping it.
- The product can smell if it has lot of dust having not cleaned for a while.

Although foreign materials on the cistern and the discs would not make them look good, they do not affect the function of the product. Also, the contaminated foreign materials are not discharged so there is no need to worry.

3.11 Cleaning (separation washing – one time per month)

Separation and cleaning of the disks should be carried out once a month.

(If there are much dust and odor in the surrounding, it should be done twice a month.)

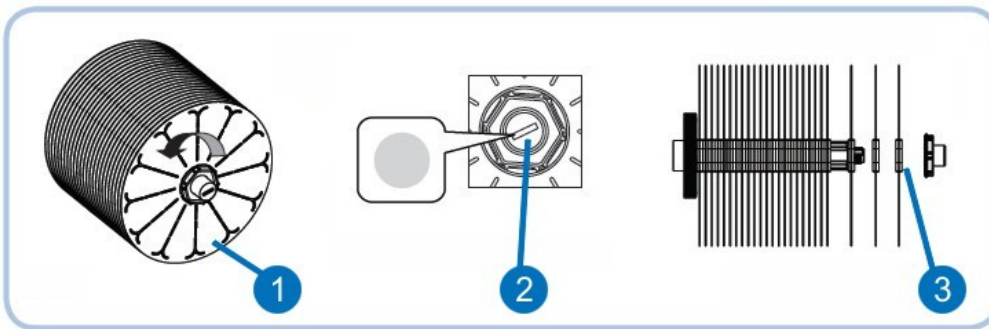

1. Please insert the Easy Kit (brush) into a cap, turn it in an anti-clockwise direction and separate it after opening the cap.
2. When there is not the Easy Kit (brush), please insert a coin into the front of the cap and open it after turning it in an anticlockwise direction.
3. By pushing from the front side consecutively, it is easily separable in whole.

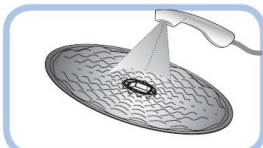

Cleaning the Disc Set

Preparation cleaning by water using shower.

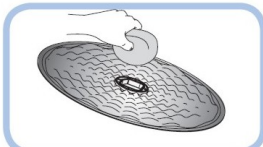

Scrub the front and back of the disc with laundry brush or scrubber using laundry detergent. (If too much scale occurs, use scale remover.)

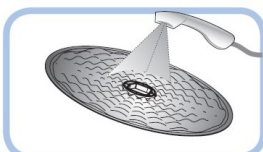

After cleaning, rinse with shower water again.

Assembly Order : Axis → Gear disc → Discs → Gear disc → Cap

Turn cap clockwise until the disc fasten and does not move. If you use the Easy Kit(Brush), you can tighten the cap easily.

3.12 Cleaning (Pre filter – once a month)

Please clean as following if the air-suction fan and its area are very dirty.

Caution: Always disconnect power before cleaning the product.

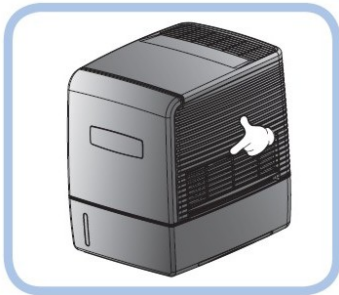

Push the inlet grille lightly both side of the upper body and open it.

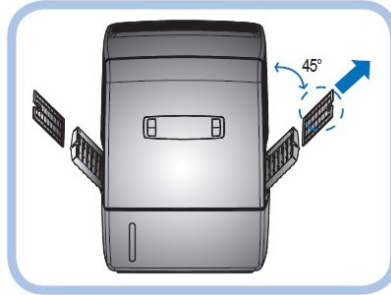

Take out the pre filter

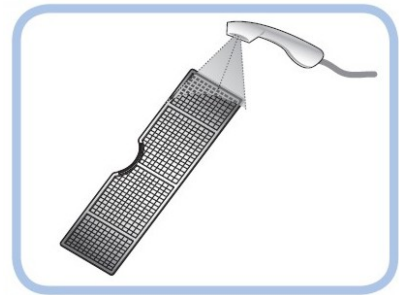

Clean the prefilter with smooth sponge and rinse with fresh water.

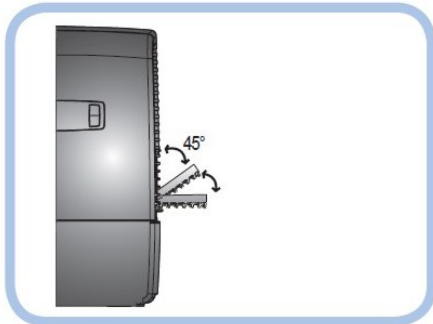

If the grille is polluted heavily, push the grille below and separate it.

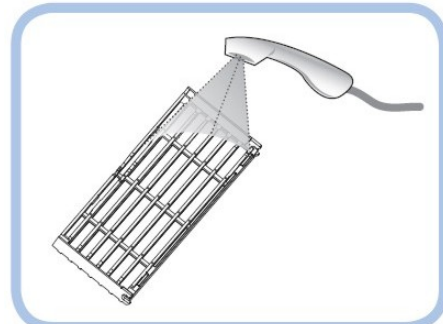

Clean the grille with smooth sponge and rinse with fresh water. Assemble the grille in reverse order with a slope of 45 degree.

3.13 Cleaning (Dust sensor: every six months)

Clean the dust sensor every six months regularly. In the heavily polluted area, clean it every three months.

Caution: Be sure to unplug the product before replacing.



Remove the sensor cover in the back side.

Caution

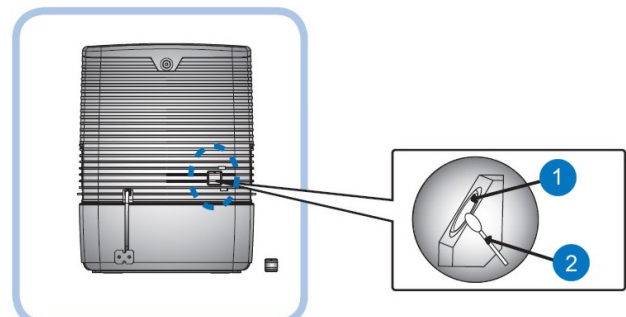

Wipe the lense (1) with cotton swab (2) carefully.

1. If it is hard to wipe the spot on the lense, clean the lense with a light wet cotton swab. Then wipe the lense with a dry cotton swab.
2. Do not clean with thinner, benzene or alcohol. It might occur the lense's damage.
3. After cleaning, reassemble the sensor cover to its original position.

4 Troubleshooting and fixing problems

Criteria to check before requesting for service.

| Condition | Criteria check |
|--------------------------|--|
| Strange sound | <ol style="list-style-type: none"> 1) Are you operating it on a flat surface and not on a decline? <ul style="list-style-type: none"> • Designate a flat surface and move it to that location. 2) Are there articles that block the flow of air around the product? <ul style="list-style-type: none"> • Remove the article that obstructs the operation around the product. 3) Have you assembled the upper part and the lower part cistern without unnecessary space? <ul style="list-style-type: none"> • Match the front part of the cistern lower part with the front part of the upper part main body (console) 4) Is disc cap properly assembled? <ul style="list-style-type: none"> • If disc cap is loosened, noise like “tick tick” could be heard, so please check it and tighten up cap. |
| Fan does not turn | <ol style="list-style-type: none"> 1) Does the direction of the upper part main body and the lower part cistern match? <ul style="list-style-type: none"> • Match the frontside of the lower part cistern with the upper part of main body frontside (console) 2) Are there any holes between upper part main body and the lower part cistern? <ul style="list-style-type: none"> • The upper part main body and the lower part cistern have to be adjacent without any holes in order to operate properly. 3) Do you see the ‘out-of-water’ sign? <ul style="list-style-type: none"> • If the water goes below the minimum line, the operation stops. • The operation starts again if you supply water. 4) Are there any sticks or foreign materials stuck around the fan area? <ul style="list-style-type: none"> • Due to carelessness, if there are any foreign materials stuck around the fan area, remove them. |
| Disks do not turn | <ol style="list-style-type: none"> 1) For the upper part of the main frame and the lower part of the cistern do the direction match and are they placed correctly? <ul style="list-style-type: none"> • Match the upper part main body frontside (console) with the lower part cistern frontside. 2) For inside the product, are the disks placed in its correct location and direction? <ul style="list-style-type: none"> • Please adjust the disc to be set into its original place. 3) Is the cap for the disk assembly loose? <ul style="list-style-type: none"> • Please turn the cap clockwise to fasten it. 4) In automated/sleeping mode, the fan stops if the room humidity exceeds 60%. 5) Haven't you stopped the operation? <ul style="list-style-type: none"> • Please press the power button on the left. |

Frequently asked questions.

| Main inquiry | Content |
|--|--|
| The water level does not decrease | <ol style="list-style-type: none"> 1) According to the seasons, the surrounding moisture conditions, temperature and others, the evaporation amount can differ. <ul style="list-style-type: none"> • For summer, area of high moisture or low temperature, the evaporation of the water decreases. 2) The product does not function properly. <ul style="list-style-type: none"> • For [the fan does not turn] and [the disks do not turn] please follow the recommended measures. |
| Is it really humidifying? | <ul style="list-style-type: none"> • The airwasher is a natural evaporating humidifier. Unlike the general humidifier, which forces the water to atomize using the ultrasonic-wave method or the multiple method product, you cannot see the results. |

| | |
|--|--|
| | <ul style="list-style-type: none"> You might not feel the humidifying effect of the airwasher for first several days of using it. This is because the surrounding environment like furniture, bed, floor, or wallpaper absorbs the moisture. You may start to feel the optimally humidified environment after a week. Please check the humidifying ability through the water decrement. |
| Is the humidifying effect good? | <ul style="list-style-type: none"> It has better humidifying ability that ultrasonic or heating humidifier since it reaches fast to optimal humidity level. Also, unlike the atomizing process of the ultra-sonic method, the area around the humidifier does not become damp. |
| Can you breath comfortably? | <ul style="list-style-type: none"> Due to the atomizing condition of the ultra-sonic method, the water particles makes breathing difficult. For the natural humidifying method, even if the moisture rises, there is no discomfort for breathing due to the natural status of the moisture maintaining method. |
| Does the air become purified? | <ul style="list-style-type: none"> For much of the odor of the air, it can easily dissolve by alcohol in the water. The airwasher, which uses water as a pure filter, helps to eliminate toxic gases. |
| How often do I have to resupply water in the cistern? | <ul style="list-style-type: none"> Supply water below the water level mark as you see the 'out-of-water' display. (once a day or two days). The water resupply differs with the surrounding moisture, temperature and situation. |
| Can the water in the cistern become disinfected? | <ul style="list-style-type: none"> By the disinfectant device (BSS: Bio Silver Stone), more than 99.9% can be disinfected so there is no need for any worry. But, please be sure to wash surely one time a week. |
| The color of the disinfectant device has changed! | <ul style="list-style-type: none"> This is due to the silver ionization of oxygen in the disinfectant device (BSS) and it will have no effect on the function whatsoever. |
| Does the contaminated water evaporate? | <ul style="list-style-type: none"> Even if the water of the cistern is contaminated by the dust or foreign materials, only pure water is humidified so there is not need for any worry. |
| I found the (%) display blinking. | <ul style="list-style-type: none"> Most of the case, it is due to temporary error in sensing interior humidity. Try to unplug the power cord for 10 seconds and reconnect it. If the problem persists, please call our customer service. |
| Can I add perfume (aroma) products? | <ul style="list-style-type: none"> As a phenomenon damaging or breaking the surface can occur by reacting with plastic products, please don't use it. |
| It smells. | <ul style="list-style-type: none"> When dust and smell are severe according to a use environment and it is not washed more than one time per week (especially a rainy period), smell can be generated. If you dissolve proper amount of Lux or a washing agent to water and wash it, the smell is removed |

As a defect is not considered following:

- Device works quietly but not completely silent. Noise less than 35 dB is normal.
- Humidity sensor works just as indicator. It means that ambient humidity can be different up to +/- 10%.

Caution! If your device fails to work despite these tips, please contact the supplier from whom you purchased it.

5 Technical specification

| | |
|---------------------------|--|
| Description | Multifunctional air cleaner and humidifier |
| Model | AWX-70PTOC(CZ) |
| Electricity consumption | 24 W |
| Max. humidifying capacity | 300-700 ml/h |
| Air volume | 210 m ³ /hod |
| Cistern capacity | 9 l |
| Product size | 325 x 420 x 410 mm |
| Product weight | 10 kg |
| Voltage, frequency | 220-240 V, 50/60 Hz |
| Fan speeds | high / middle / low |
| Noise | 46 db / 35 db / 25 db |
| Warranty | 2 years |

6 Waste disposal

This product has been manufactured using high-grade materials and components which can be recycled and reused.

The European directive 2012 / 19 / CE on Waste Electrical and Electronic Equipment (WEEE), requires that old household electrical appliances must not be disposed in the normal unsorted municipal waste stream. Old appliances must be collected separately in order to optimize the recovery and recycling of the materials they contain and reduce the impact on human health and the environment. The crossed out “wheeled bin” symbol on the product reminds you of your obligation, that when you dispose of the appliance it must be separately collected. Consumers should contact their local authority or retailer for information concerning the correct disposal of their old appliance.



All rights for any technical modifications are reserved

EU importer
Bibetus s.r.o.
Loosova 262/1, Brno 638 00, Czech republic
info@bibetus.cz