

# **Air purifier**

# **Airbi GUARD**



## **Instruction manual**

(version 1.0)



Please read the instruction manual carefully before using this appliance!

## Important safety instructions

---

Please read through the operating instructions carefully before you use the appliance for the first time and keep them safely for later reference. If necessary pass them on to the next owner.

1. The appliance is only to be used in the home for the purposes described in these instructions. Unauthorised use and technical modifications to the appliance can lead to danger to life and health.
2. This appliance can be used by children aged from 10 years and above and persons with reduced physical, sensory or mental capabilities or lack of experience and knowledge if they have been given supervision or instruction concerning use of the appliance in a safe way and understand the hazards involved. Children shall not play with the appliance. Cleaning and user maintenance shall not be made by children without supervision.
3. After unpacking, make sure that appliance wasn't damaged during transport. If you find any damage, contact your dealer as soon as possible. We recommend you keep the packaging for possible future use .
4. Before first use check that the device parameters (electric voltage, etc.) correspond to local conditions.
5. Use appliance in an environment of 10°C to 30°C. Do not use outdoors.
6. Please put appliance more than 1 meter away from TV or radio. It is recommended to put appliance on a flat ground in the room.
7. Do not place the appliance near a heat source. Do not subject the power cord to direct heat (such as a heated hotplate, open flames, hot iron sole plates or heaters for example). Protect power cords from oil.
8. Always put the appliance on a hard, flat horizontal surface. There should be a gap of at least 20 cm at both sides and back of the product, while 30 cm from top surface.
9. Do not place anything on the appliance and do not block the air inlet and outlet.
10. Before using the appliance, check if AC adapter or power cord is not damaged. Do not use it if the cord is damaged.
11. If the power cord is damaged, it must be replaced by the manufacturer or a repair shop authorized by the manufacturer or by similarly qualified persons in order to avoid a hazard
12. Switch off and unplug the unit before any manipulation such as cleaning of filters maintenance.
13. Do not lift or move the appliance when it is working.
14. Do not touch the power cord with wet hands, may cause electric shock.
15. Do not insert fingers or metal objects into the air outlet gap, may cause electric shock.
16. Do not let water, flammable detergent or other liquid get into the product, may cause electric shock or fire.
17. This product is not supposed to be used as daily ventilator, dust cleaner or cooker hood.
18. Do not place appliance in too humid or too hot places.
19. Do not use the appliance in aromatherapy scent insecticide environment.
20. Store the appliance in a dry place inaccessible to children (pack the appliance).
21. Manufacturer is not responsible for any damage due to improper use of appliance.

## Packing list

---

- appliance
- combi filter (3in1)
- user manual

## Purifier's scheme

---

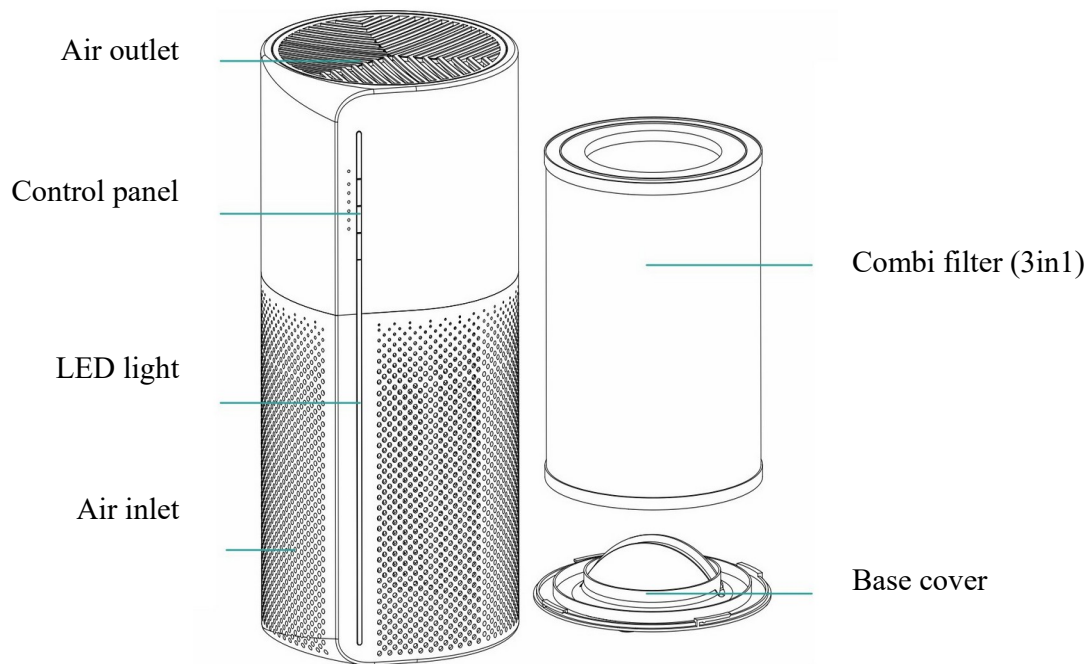

## Before first use

---

1. Turn base cover anti-clockwise and remove it.
2. Take out the filter from unit.

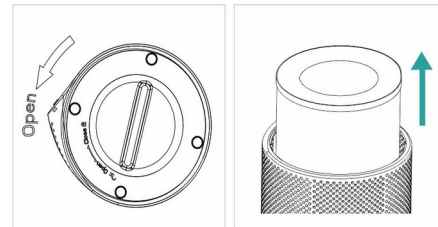

3. Remove packaging from filter.

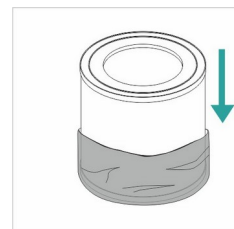

4. Install filter inside unit.
5. Put back base cover and turn it clockwise.

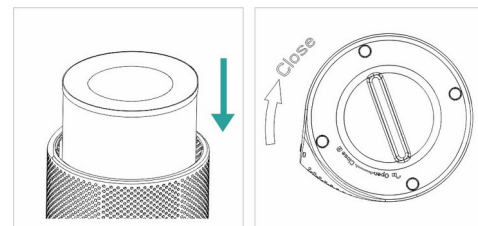

## Control overview

---



Power button

L-H-A



Mode button (L – low power, H- high power, A – automatic mode)

2H-4H-8H



Timer button



LED light button

## Operation instruction

---

After you connect power adapter to air purifier and then to electric socket, you hear sound notice and the blue LED backlight and all button's LEDs light up for 1 second.

### Power button

Press the button to turn on the device. The first time the device is started, it will start in detection mode (this also applies after power up after a power failure or reconnection to a power outlet). In this mode, the indoor sensor tests the ambient air (LED light changes its color smoothly) and fan power is set to low. After 30 seconds, LED light indicates current air quality see. paragraph Air quality indication. Press the button again to turn off the device. When you turn it back on, the device will automatically start in the last mode it was last turned off.

### Mode button

Use this button to change working mode of purifier - low (L), high (H) and automatic (A). The selected mode is indicated by the LED besides letters L, H, A. In automatic mode, the fan speed is dependent on the ambient air quality. If the air is poor, the LED light is red and the fan is set to high power. If the air quality is average, the LED light is orange and the fan is set to medium power. If the air is good, the LED light is blue and the fan is set to low power.

### Timer button

By pressing the timer button repeatedly the user can set timer for 2, 4 or 8 hours. Preset time is indicated by LED on top panel that is light on. If timer's LED doesn't light on it means timer is not active.

### LED lighting button

Press the button to dim the LED illumination. Press it again to turn it off and press it again to turn the backlight on.

### Air quality indication

Air quality indicator informs user about ambient air quality. Color of the LED backlight informs user about the air quality around the device. Blue indicates good air quality, orange indicates poor conditions and red indicates poor quality.

## Product care and maintenance

---

### Combi filter (every two months)

- Use the vacuum cleaner to clear the dust on the surface of the screen.
- Place the filter into the ventilated place. Don't expose under the strong sunshine.
- Do not use water to clean the filter.

### Tips

- Ensure to disconnect the power before cleaning and maintenance.
- Please unplug power if the appliance is not in use in long time.
- According to the use of places and methods (e.g. family with many of smokers or the place with serious pollution), the filter life will be shortened. Please replace the filter in time.
- To clean the device, do not use any aggressive concentrated detergents.
- The device operates quietly, but not completely noiseless. Noise below 55 dB is not considered a malfunction.

## Filtration system

---

1. **Pre-filter:** Dust capturing filter at the front. Is able to filter pollutants like large dust particles, hairs, pollen, suspended particles, etc. Is washable and reusable
2. **Activated Carbon Filter** - Absorbs various smells, such as formaldehyde. This colourless gas with a strong odor is often considered the most dangerous harmful substance inside flats because it is highly irritating for the upper airways and eyes.
3. **True HEPA filter:** Adsorbs particulate down to 0.0001mm like pollen, drifting dust and germs with purification efficiency of more than 99.9%. Prevention of the spread of airborne bacterial and viral organisms.

## Replacing the filters

---

The device is equipped with a filter change indicator. This function is set to 2200 hours of operation. When this time has elapsed, the LED light starts automatically flashing in red color. If this situation occur, please replace the combi filter. Pressing and holding the power button for 7 seconds will reset this function.

1. Turn base cover anti-clockwise and remove cover.
2. Take out the filter.
3. Remove packaging from new filter and insert it inside unit.
4. Put back the base cover and turn it clockwise.

## Troubleshooting

---

Trouble	Solution
Can not turn on or button has no response	<ul style="list-style-type: none"> <li>• Check the power cord if is plugged in.</li> </ul>
Air is dirty, but the indicator still show green color.	<ul style="list-style-type: none"> <li>• The air quality sensor is dirty and must be cleaned (eg with a vacuum cleaner).</li> </ul>
Strange sound during operation.	<ul style="list-style-type: none"> <li>• Check if you removed filter bags.</li> <li>• Check whether the input / output of the air is blocked by</li> </ul>

	something.
Strange smell from appliance.	<ul style="list-style-type: none"> <li>• Filter is dirty, clean or replace filter.</li> </ul>
Purifier work time is long, but air quality not improved.	<ul style="list-style-type: none"> <li>• Check if you removed filter bags.</li> <li>• Check for any source of contamination nearby.</li> </ul>

***Note: If none of the above tips remedies the fault, always contact the service department designated by the distributor. Never attempt to repair the unit yourself!***

## Technical specifications

Rated voltage	Input 220-240 V, 50/60 Hz, Output 24V 1,2A
Power	23 W
Noise	<55 dB (A)
Air performance	120 m <sup>3</sup> /h
Max. room dimension	16 m <sup>2</sup>
Dimensions	195 x 195 x 388 mm
Weight	2 kg

## Disposal of the device (environment)

The European directive 2012 / 19 / CE on Waste Electrical and Electronic Equipment (WEEE), requires that old household electrical appliances must not be disposed in the normal unsorted municipal waste stream. Old appliances must be collected separately in order to optimize the recovery and recycling of the materials they contain and reduce the impact on human health and the environment. The crossed out “wheeled bin” symbol on the product reminds you of your obligation, that when you dispose of the appliance it must be separately collected. Consumers should contact their local authority or retailer for information concerning the correct disposal of their old appliance.



This product is in compliance with the essential requirements and other relevant provisions of EMC directive 2014/30/EU. The device was approved for use in EU countries, therefore, bear the CE. All necessary documentation is available at the importer address.

Changes in technical parameters, properties, printing errors in the instruction manual reserved.

Importer address:  
 Bibetus s.r.o.  
 Loosova 262/1  
 Brno 638 00  
 Czech republic  
 E-mail: info@bibetus.cz