

Aroma diffuser

Airbi CANDLE

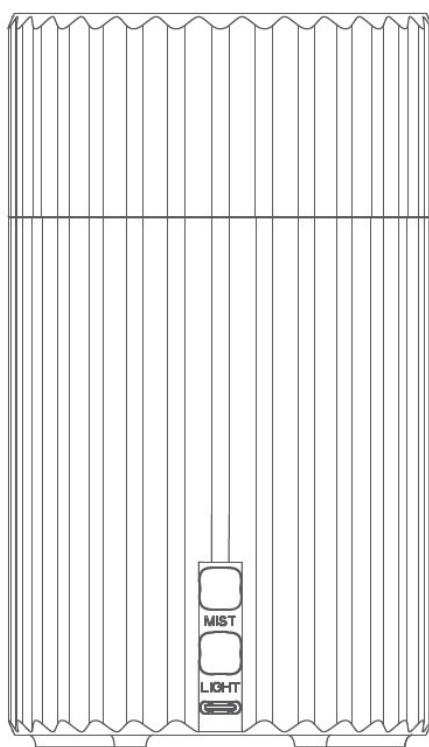

Instruction manual

(version 1.0)



Please read the instruction manual carefully before using this appliance!

Important safety instructions

Please read through the operating instructions carefully before you use the appliance for the first time and keep them safely for later reference. If necessary pass them on to the next owner.

1. The appliance is only to be used in the home for the purposes described in these instructions. Unauthorised use and technical modifications to the appliance can lead to danger to life and health.
2. This appliance can be used by children aged from 10 years and above and persons with reduced physical, sensory or mental capabilities or lack of experience and knowledge if they have been given supervision or instruction concerning use of the appliance in a safe way and understand the hazards involved. Children shall not play with the appliance. Cleaning and user maintenance shall not be made by children without supervision.
3. After unpacking, make sure that diffuser wasn't damaged during transport. If you find any damage, contact your dealer as soon as possible. We recommend you keep the packaging for possible future use .
4. Before first use check that the device parameters (electric voltage, etc.) correspond to local conditions.
5. Do not inhale!
6. Use appliance in an environment of 10°C to 30°C. Do not use outdoors.
7. Do not place the appliance near a heat source. Do not subject the power cord to direct heat (such as a heated hotplate, open flames, hot iron sole plates or heaters for example). Protect power cords from oil.
8. Always put the diffuser on a hard, flat horizontal surface, at least 15cm from the walls and away from any source of heat such as burners, radiators etc. The diffuser cannot operate on a surface that is not horizontal.
9. Before using the diffuser, check if AC adapter or power cord is not damaged. Do not use it if the cord is damaged.
10. If the power cord is damaged, it must be replaced by the manufacturer or a repair shop authorized by the manufacturer or by similarly qualified persons in order to avoid a hazard
11. Only use tap water.
12. Don't exceed the maximum water level. Always put the water before essential oils. Never use pure essential oils without water. Put some essential oils (1-2 drops). Too much drops may damage the unit.
13. Continued use of the diffuser in the long-term damage to the product and shorten its life.
14. Unplug the unit before any manipulation such as cleaning of filling for example. Always empty the tank when the unit is not in use.
15. Do not remove the cover of the diffuser when the unit is running.
16. Refill frequently the water in the tank to prevent any dirt that could damage the unit.
17. Clean the water tank every week. Do not use any chemical products (acids,...) or corrosive product to clean the device.
18. In case of splashing water in the circuit, remove the diffuser immediately and let it dry in the open air for at least 3 days.
19. Store the appliance in a dry place inaccessible to children (pack the appliance).
20. Only use fragrances, aromas or essential oils that do NOT contain alcohol. Alcohol can damage the appliance. Appliances that are damaged by such additives are not covered by the warranty.
21. Manufacturer is not responsible for any damage due to improper use of appliance.

Diffuser's scheme

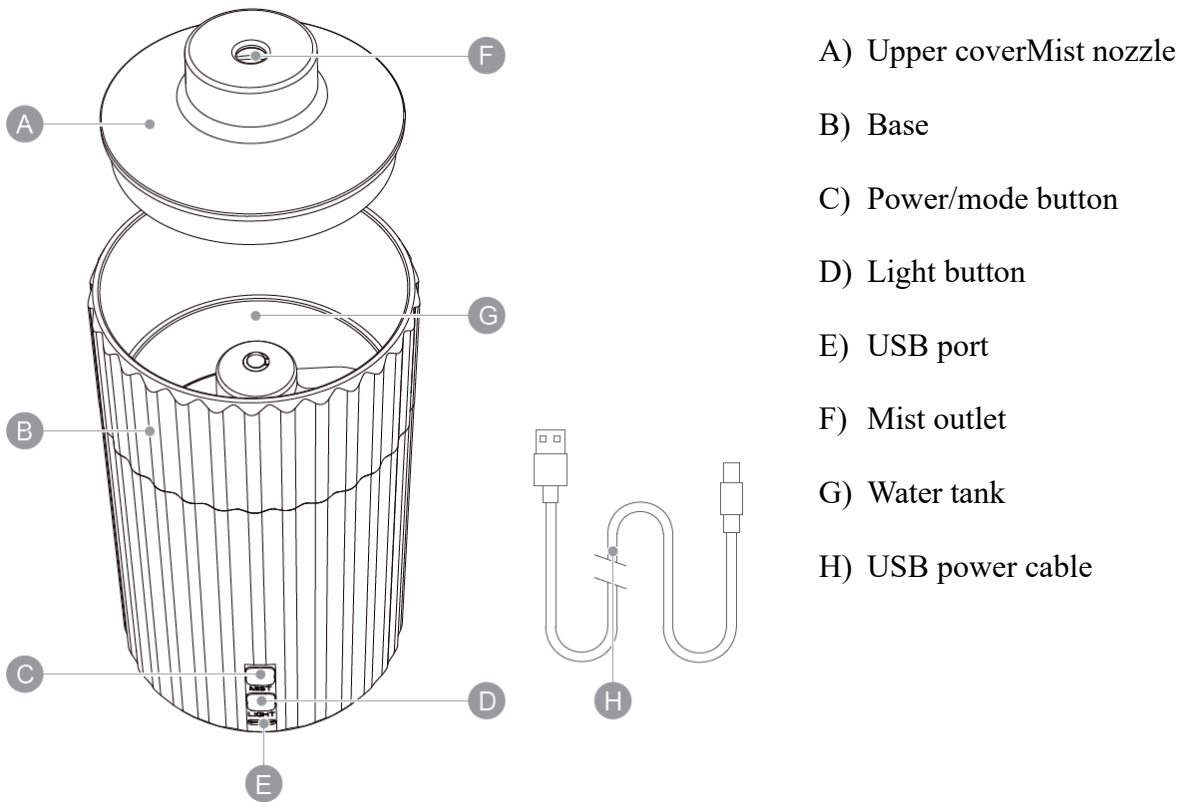

Operation instructions

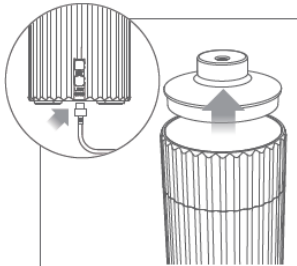

Place the product on a flat surface and connect the USB-C power cable to it to turn on the device. Then remove the lid.

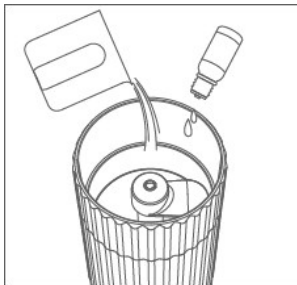

Add water and essential oil to the reservoir. Do not exceed the maximum water level and do not use hot water.
 (We recommend adding a maximum of 5 drops of essential oil per 100 ml of water)

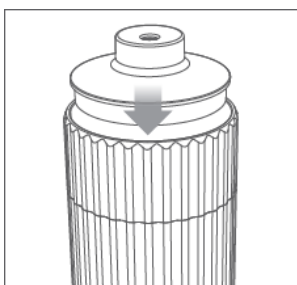

Put the lid back on the device.

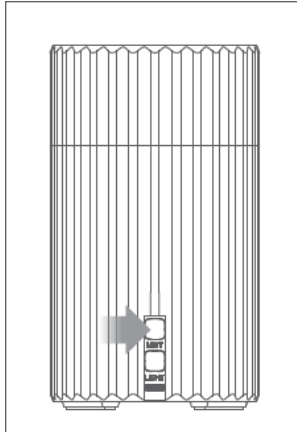

Mode selection button

When pressed for the first time, the backlight and steam will start. By default, the strongest backlight and continuous steam mode is on.

When pressed a second time, the interval steam mode starts (30 seconds on, 30 seconds off), the backlight is unchanged.

After the third press, both the backlight and steam generation are switched off.

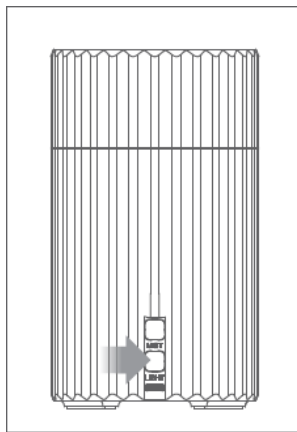

Backlight button

By default, the backlight is turned on to the strongest level.

You can use this button to select one of the three backlight levels or turn it off completely.

Note: the backlight can only be switched on when steam is being produced.

Notice

The appliance switches itself off as soon as the water in the water tank is almost empty. The amount and intensity of produced mist vary, but this is not unusual and should not be considered as a defect. The device works quietly, but not completely silent. Noise below 40 dB is not considered as a defect. If you want to use a different kind of essence, always clean water tank properly.

Product care and maintenance

1. Before any cleaning, turn off the unit and disconnect it from the power supply.
2. Periodically clean the ultrasonic diaphragm with a soft cloth soaked in water and vinegar.
3. Do not clean the instrument with thinner, gasoline or any other cleaning agent, but only with a damp cloth soaked in detergent water. Then wipe the instrument dry with a second cloth.
4. Pour out the water when the instrument is not in use.
5. Keep the unit dry when not in use to prevent bacteria and mould from forming. Clean the appliance before each use.
6. Never immerse the unit in water or allow water to enter the internal parts of the unit.

Problems and solution

When you switch on appliance, it will switch off in 1 second.	<ul style="list-style-type: none"> • check water tank if there is water or not • check if AC adaptor is connected correctly
Without mist spray or abnormal mist spray.	<ul style="list-style-type: none"> • check water tank if there is water or not, also check if water is under max. line • clean water tank

	<ul style="list-style-type: none"> • check air inlet and clean it from dust
Water leakage.	<ul style="list-style-type: none"> • check if upper cover is placed correctly • check ambient temperature and humidity (too low temperature or too high humidity may lead to mist get easier together and form water drops)

Technical specifications

Power supply: USB adapter DC 5 V/1A
 Rated power: 5 W
 Dimensions: 8,8 x 15,4 x 8,8 cm

Weight: 235 g
 Water tank capacity: 100 ml
 For rooms: 10-20 m²

Disposal of the device (environment)

The European directive 2012 / 19 / CE on Waste Electrical and Electronic Equipment (WEEE), requires that old household electrical appliances must not be disposed in the normal unsorted municipal waste stream. Old appliances must be collected separately in order to optimize the recovery and recycling of the materials they contain and reduce the impact on human health and the environment. The crossed out “wheeled bin” symbol on the product reminds you of your obligation, that when you dispose of the appliance it must be separately collected. Consumers should contact their local authority or retailer for information concerning the correct disposal of their old appliance.



This product is in compliance with the essential requirements and other relevant provisions of EMC directive 2014/30/EU. The device was approved for use in EU countries, therefore, bear the CE. All necessary documentation is available at the importer address.

Changes in technical parameters, properties, printing errors in the instruction manual reserved.

Importer address:
 Bibetus s.r.o.
 Loosova 262/1
 Brno 638 00
 Czech republic
 E-mail: info@bibetus.cz