

## Multifunctional air cleaner and humidifier

# Airbi AIRWASHER

Model: AWE-25PTOH(CZ)



## Instruction manual

(version 1.0)



- Please make sure to read the instruction manual carefully. This information will help you to familiarise yourself with your new device, to learn all of its functions and parts to find out important details about its first use and how to operate it, and to get advice in the event of faults.
- Following and respecting the instructions in your manual will prevent damage to your instrument and loss of your statutory rights arising from defects due to incorrect use. We shall not be liable for any damage occurring as a result of non following of these instructions.
- Likewise, we take no responsibility for any incorrect readings and for any consequences which may result from them.
- Please take particular note of the safety advice!
- Please keep this instruction manual for future reference.

## 1 Features of Airbi AIRWASHER

---

The Airbi AIRWASHER is humidifier and also a air cleaner that rapidly intakes dry and contaminated air and turns it into humidified, fresh, clean and healthy air.

Basic features of Airbi AIRWASHER:

1

Optimum humidity level is generated by natural evaporation.

Although the humidificaton process is not visible like other humidifiers, the optimum humidity level(40~60%) is automatically generated by natural evaporation. Large water particles that are visible to the eyes are heavy and may aggravate the respiratory organs and hazardous to health.

2

Unique disinfection system with the environmental-friendly material, BSS

BSS (Bio Silver Stone), non-chemical material, kills and eliminates various kinds of germs and viruses inside the water tank. (Germ killing by more than 99.99%).

3

Very easy for cleaning water tank and refilling water.

The water tank which has a flat surface inside can be separated from the main body(upper unit). It is very convenient for cleaning water tank and refilling water in the tank.Cleaning once a week is enough for maintaining the germ- killing power.

4

The air is cleaned without replacing an air purifying filter. The water in the tank washes the air.

The water absorbs not only dusts and bad smells but also formaldehyde which cause atopic dermatitis in a newly built house. Breathe the fresh air from Airbi airwasher and feel the freshness like the moist clean air after the rain.

## 2 Safety advices

---



Criteria for possible critical danger to life or fire if not complied.

Criteria of possible danger to health or damage to the product if not complied.

### 2.1 Important criteria before usage



The product is only for domestic use in 230V 50Hz voltage.

- If voltage other than 110V is used, the product can become defected or fail to function.
- For overseas uses when the voltage is different, it may fail to work or fire may ensue.

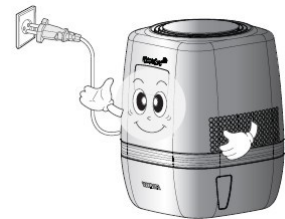

Please avoid exposure to direct light, places of high heat or near heaters.

- Change of color or form may occur in the exterior of the product.
- If the product is too near a heater, fire may occur.

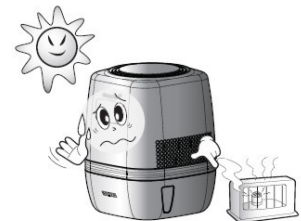

Please use it on a solid and flat floor

- If the floor is tilted, sound may be created or the internal parts may alter in form.
- Instead of on a table, using it on a floor can be safer.



Do not handle the electrical cord with wet hands.

- If water is contacted, electrocution may occur.

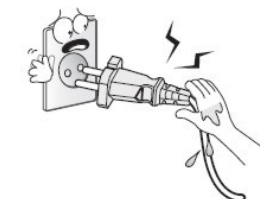

## 2.2 Important criteria to follow for operation and management



Caution

Do not use too near the wall.

- Since the humidified and clean air is supplied from the front, right and left sides, it should be placed at least 30cm from the walls. (for the back, 10cm space should be allowed)
- Sufficient ventilation is important for the product to function effectively.

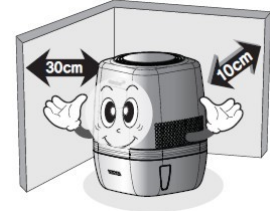

Caution

Don't use it close to other electric housing appliance.

- Keep at least 30cm of distance from them to minimize harmful effect.



Warning

Do not sit or step on the product.

- The product may be broken and/or cause injury. (Especially be careful of children's behavior).



Warning

If smoke or a burning smell are detected, unplug the product immediately to stop operation and call customer service.

- Danger of product damage, electric shock and fire.



Warning

Please do not use flammable spray near the product

- Danger of fire and the plastic sides may damage.

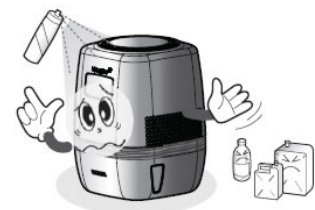



Please don't use harmful substance to plastics

- There may be harmful influence(breaking, etc.) to plastic products when perfume products(aroma) is used.
- If you use it near a kitchen, oil components were splashed to damage or contaminate plastic products, so it may be difficult for you to clean the plastic products.

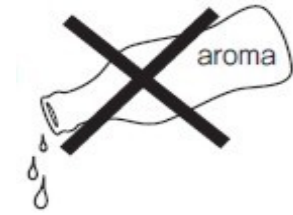

Please do not pour hot water.

- The product may change form or lead to malfunctioning.
- Use cool or lukewarm water which is under 40°C.



Do not forcefully enter sticks or fingers into the intake or the exhaust or attempt to independently remodel or separate the product.

- May lead to product malfunction or inflict injuries.
- In case of need, please contact customer service.



When in operation, do not use clothing, towels or others on top.

- It may lead to heating.
- The top part of the product is for intake of dry and contaminated air.

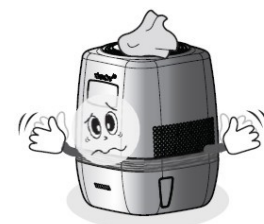

Do not use the product near the hair.

- When sleeping, do not place it near your head. The evaporation of cold air could cause cold. Place it in distance from your sleeping position.

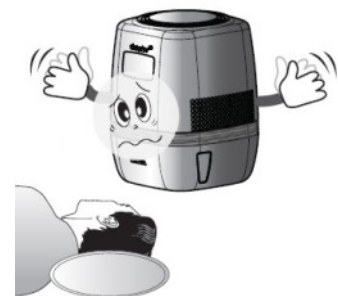



Caution

Stand the body up while cleaning or supplying water.

- Damage to the product surface may occur if you lay it down.



Caution

Do not handle with force the disinfectant device (BSS) surface

- The content may damage.

Do not separate or eat the disinfectant device or use it for other purpose without consultation.

- The disinfectant material may affect the respiratory organs.



Warning

Do not handle with force the disinfectant device (BSS) surface

- The content may damage.

Do not separate or eat the disinfectant device or use it for other purpose without consultation.

- The disinfectant material may affect the respiratory organs.



Caution

When moving the product, move the upper main part and the lower cistern separately.

- When moving, the internal water may spill.





When not in use for an extensive time, empty out completely the water in the cistern, clean the cistern and the disk and store after drying.

- Otherwise, contamination may occur.
- If not in use for more than two days, empty out the water and turn off the electricity.



In case of power cord damage, please call our service center for appropriate repair.

- Do not disconnect the power connector from the product while the power cord is plugged in the socket.



Clean or supply water after plugging out from the power.

### 3 Correct Operation

#### 3.1 Installation

After moving to place of installation read the [Safety Advices] first and use if as follows.

After removing the product from the package, remove the packing material and the vinyl like the drawing and then remove the interior tape of the product and the interior packing material.

If operated without removing the inside packaging material, the product does not operate or may be broken.

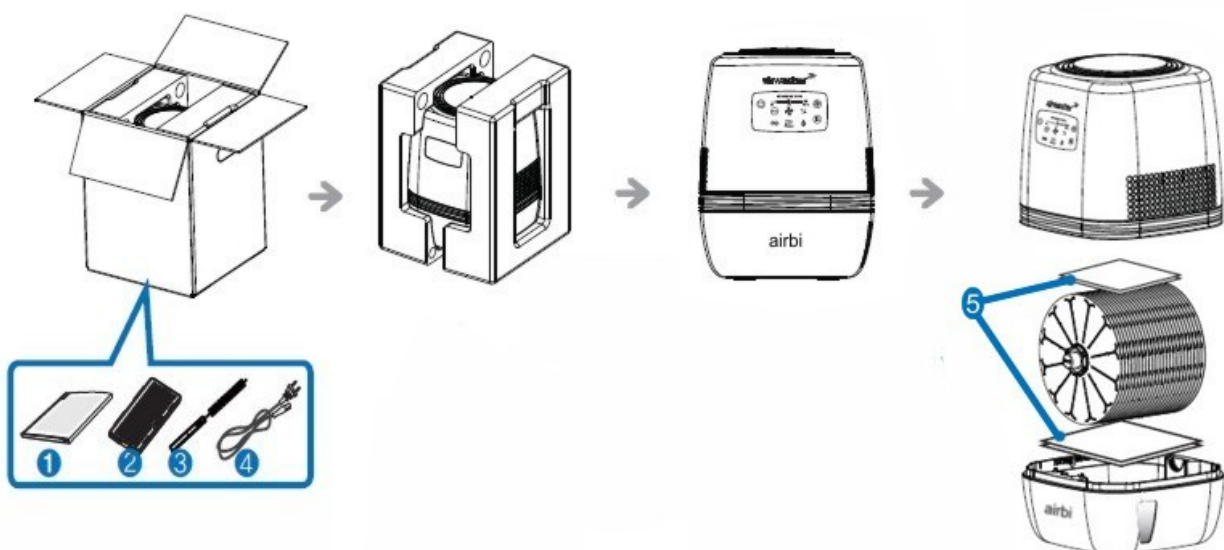

You will find in the box

- |                |                       |
|----------------|-----------------------|
| 1. User manual | 3. Easy kit (brush)   |
| 2. BSS filter  | 4. Power cord         |
|                | 5. Packaging material |



### 3.2 Product overview

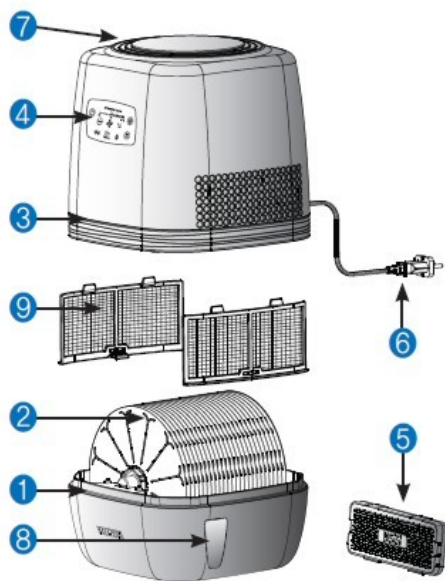

1. **Cistern** - A place to store water for evaporation and air cleaning.
2. **Disk** - The water in the cistern is pumped up and a water film is formed on the surface with the water being evaporated and the minute dirt being eliminated.
3. **Body (Main Frame)** - The fan and motor that control the air flow is located here and clean air is supplied through the exit duct in the left and right side.
4. **Operating panel** - It contains power button and operation mode selection button. Also, it contains the window which shows the operational status.
5. **Disinfectant device (BSS: Bio Silver Stone)** - Placed in the floor of the cistern, it prevents and contamination.  
 ※ Although the life cycle of the disinfectant may vary, it should accommodate an operation period of 24 hours a day for about 12 month. (For repurchase of the part, please consult the customer service center.)
6. **Power cord** - Supplies Electricity to the Product.
7. **Upper cover** - The upper side is dried and the contaminated air is taken in.
8. **Water level gauge** - It is possible to see the water level from outside.
9. **Pre-filter** - It eliminates the dust of intake air first.

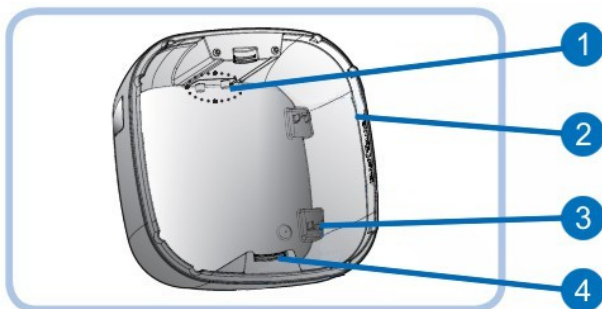

1. **Water sensor** -  
 Caution: Please wipe the sensor every week. Water level may not be detected if it is contaminated.
2. **Water level**  
 It is marked on each side of inner part of the water tank. Fill water not to exceed the line.

3. **Disinfectant device (fixed part)** - It is located inside of the tank at the bottom right.

4. **Disc fixing part** - Fix it properly on the front and back side of the disc.

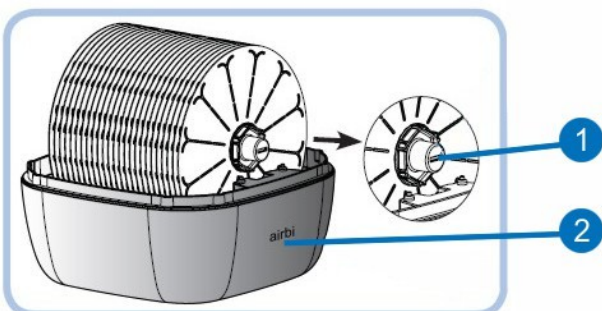

1. **Cap** – The disk is easily separated if you turn it by using a coin in case of disk washing.
2. **Warning:** The side with sticker attached is the front. The product will not operate if the front and back of the tank are changed.

### 3.3 Operation preparation



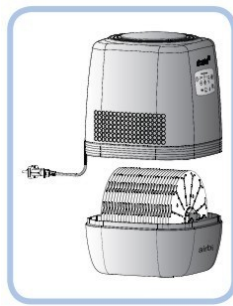

Lift up the upper part of the main frame and place it sideways.

Remove the insulation for shock absorption in the lower part of the internal disk. (When using for the first time).

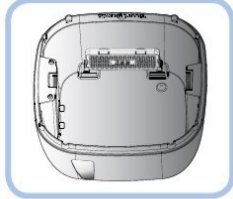

After removing the packing and the vinyl of the disinfectant device (BSS) place it into the floor of the cistern's insert part until you hear a "click" sound.

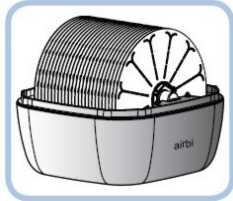

Make the side with sticker to see the front.

The product will not operate if the front and back of the tank are changed.



Fill the water no more than water level (1) marked on both sides of the tank. When using underground water, scale (lime) could form on the surface of the disk, cistern and the disinfectant device so please use tap water.



Return the upper part of the main frame to its original position. Install the cistern and the control switch in the front side.



If the direction is wrong, spacing occurs in between the upper part of the main body and the cistern so operations is not possible.

Please insert the connector to the product first and then insert the plug to the wall socket.



When disconnecting the power cord, please pull out the plug from the wall socket first and then separate the connector from the product.

### 3.4 Power on/off and operation

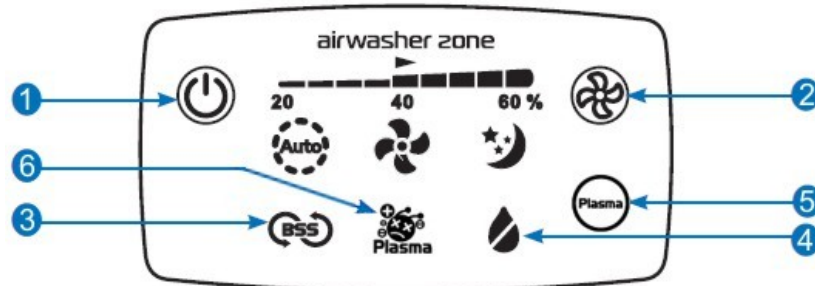

#### Button 1: Switch on/off device

Start/Stop: you can [Power] or [Stop] when you press the power button on left.

#### Button 2: Choose working modes

1) Auto : It controls its mode between super-strong-weak according to the humidity around. It stops operating if the humidity exceeds 60% and restarts if humidity becomes less than 60%.

※If humidity exceeds 60%, the humidifier stops but the airwasher operation continues so that the fan keeps operating with weak mode.

2) Super-wind Operation : It operates with its maximal mode regardless of the humidity around. Used to airwash and humidify the size equivalent to living room.

3) Strong-wind Operation : It operates with the strong-wind mode regardless of the humidity around. Used to airwash and humidify the size equivalent to inner room(big room).

4) Weak-wind Operation : It operates with the weak-wind mode regardless of the humidity around. Used to

airwash and humidify the size equivalent to small room.

5) Sleeping Operation : Runs quietly. Stops when humidity exceeds 60% and restarts when it reaches under 60%. The brightness of display window becomes half of normal condition not to disturb sleeping.

### **Button 3: BSS filter indicator**

When the life of the disinfection system has been expired (about 1 year), an indicator will appear. After replacing the BSS, please push operation selection button and hold for 3 seconds. The product will initialize.

### **Button 4: Out of water indicator**

When the water runs out, the product stops working and displays the icon on LCD panel. Operate after filling up water.

### **Button 5: Switch on/off plasma ion generator**

Switch on/off plasma ion generator

### **Button 6: Plasma ion generator indicator**

When indicator light on, function is active.

The brightness of the LCD window will be reduced to half when one minute would have passed after the last operation was selected

## **3.5 Resupplying of water**

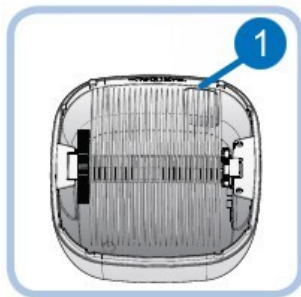

For water resupplying, just fill it with insufficient amount (1) until the sixth day but on the seventh day, remove the water remaining in the cistern and after cleaning, resupply it again.

※ Even if the water in the cistern is somewhat contaminated, only pure water is humidified so there is no need to worry.  
 ※ If you resupply the water regularly each day, it becomes more convenient.

## **3.6 Emptying of water**

If the environment surrounding has excessive dust or odor or frequent ventilation cannot be done, you must empty out the water more frequently.

After opening the main body, if the water level (1) of the cistern is at a low level, you must empty out the cistern and resupply with fresh water.

※ The remaining water has dust, foreign material, odor and others so by resupplying with fresh water, the air cleaning function is greatly improved.

Fill the freshwater below the marked water level.

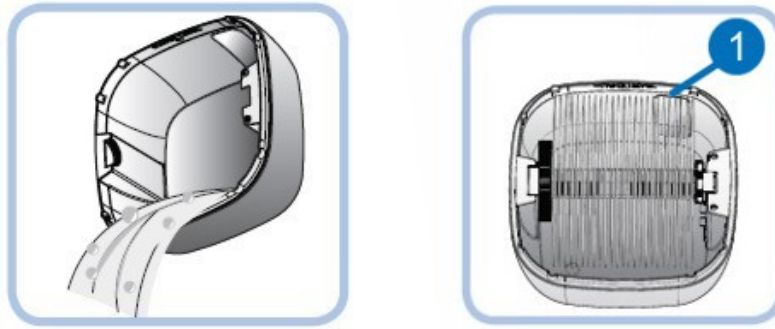

When not in use for more than 2 days, empty out the water. For reuse, resupply the water.

※ For extensive period of disuse, winged insects might enter the interior of the product which might cause the water to smell.

### 3.7 Cleaning (rotation washing – one time per week)

For cleaning the cistern, disk and the disinfectant device (BSS), they should be done once a week.

※ If much dust or odor are in your surrounding, clean twice a week.

For the upper part of the main body, do not wash with water. The product might malfunction or you might get electrocuted. It should be cleaning by a tightly squeezed wet towel for its interior and exterior.

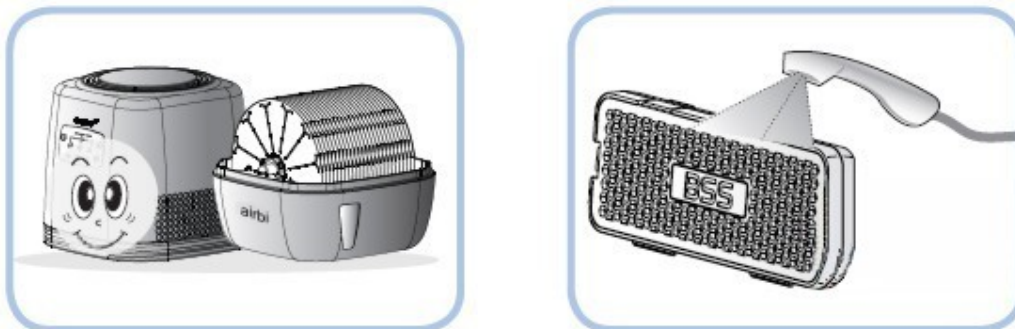

Stop operations and remove the electrical line (power cord) from the socket. Remove the upper part main body. Disinfectant device should be separated from the cistern and washed with a shower for the exterior and the net part.

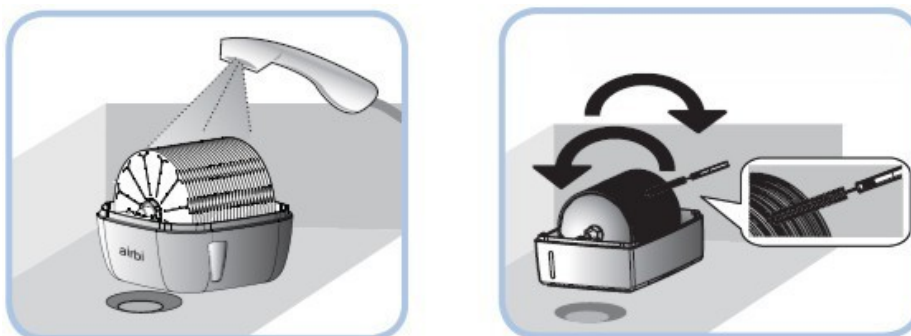

Please fill water in a cistern up to a water level and dissolve proper amount of washing detergent and make foam. Please insert the Easy Kit (brush) in the space between discs and wash it while rotating the discs with hands. If you move the Easy Kit and wash it like brushing, the effects can be enhanced.

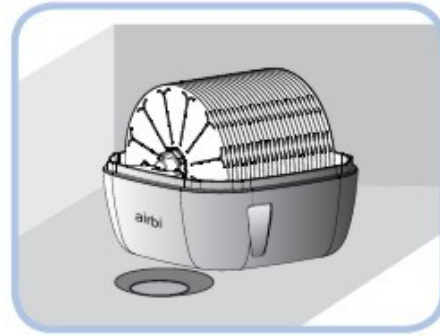
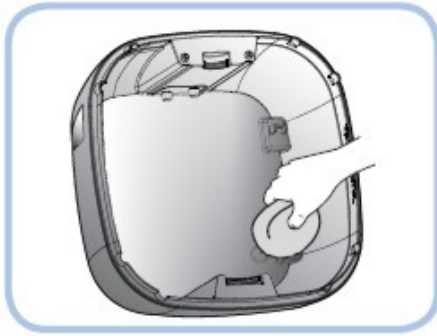

The cistern should be cleaned with a smooth sponge. Clean the water sensor inside the tank. Water level cannot be sensed well if any fur occurs on sensor. The cistern, discs and the disinfectant device should be rinsed cleanly with the disinfectant device placed in its original position in the cistern and after distinguishing the front and back of the discs, they should be lifted on.

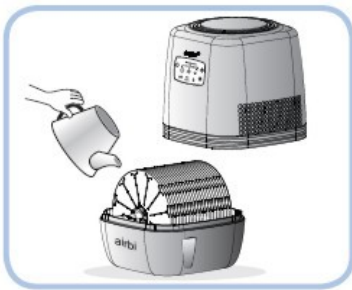

Water should be supplied to the water level of the cistern.

- We recommend to use other container or kettle when refilling water since the tank filled with water is heavy and there is a danger of dropping it.
- The product can smell if it has lot of dust having not cleaned for a while.

Although foreign materials on the cistern and the discs would not make them look good, they do not affect the function of the product. Also, the contaminated foreign materials are not discharged so there is no need to worry.

### 3.8 Cleaning (separation washing – one time per month)

Separation and cleaning of the disks should be carried out once a month.

(If there are much dust and odor in the surrounding, it should be done twice a month.)

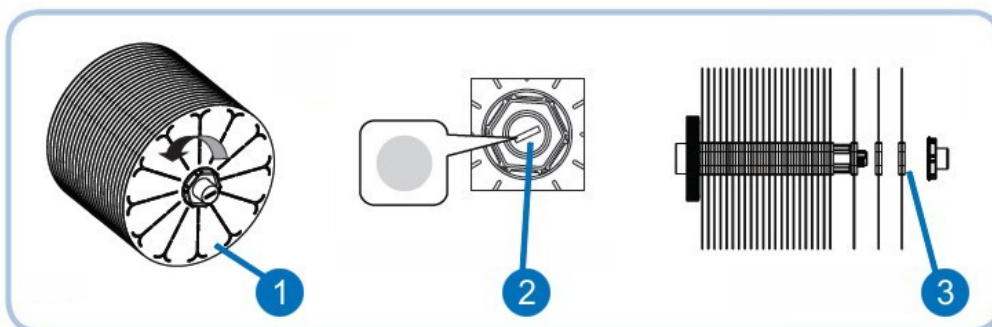

1. Please insert the Easy Kit (brush) into a cap, turn it in an anti-clockwise direction and separate it after opening the cap.
2. When there is not the Easy Kit (brush), please insert a coin into the front of the cap and open

it after turning it in an anticlockwise direction.

3. By pushing from the front side consecutively, it is easily separable in whole.

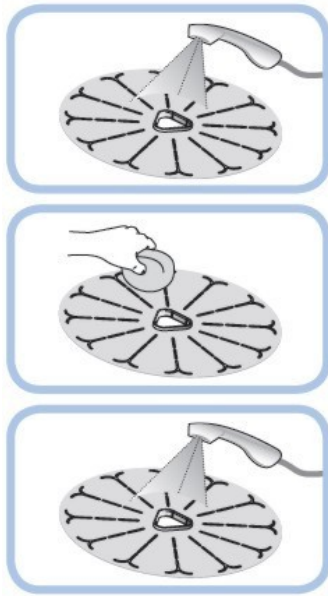

#### Cleaning the Disk Set

Preparation cleaning by water using shower.

Scrub the front and back of the disc with laundry brush or scrubber using laundry detergent. (If too much scale occurs, use scale remover.)

After cleaning, rinse with shower water again.

Assembly Order : Axis → Gear disk → Disk (28 pieces) → Gear disk → Cap

Turn cap clockwise until the disc fasten and does not move. If you use the Easy Kit(Brush), you can tighten the cap easily.

### 3.9 Cleaning (pre filter – once a month)

Please clean as following if the air-suction fan and its area are very dirty.

Caution: Always disconnect power before cleaning the product.



Open and lay down the upper main body.

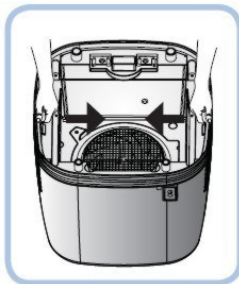

Hold the handles of pre-filter and push toward center to separate it from the main body.



Clean the filter using brush and detergent. Wash it by shower afterward.

Assemble the product in the reverse order after cleaning.

### 3.10 Cleaning (fan area)

Please clean as following when air-suction fan and its area are very dirty.

Caution: Always disconnect power before cleaning the product.



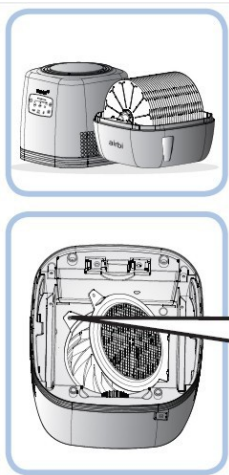

Open and lay down the upper main body. Use (+) screwdriver to loosen the cover by separating screw from the back side of the upper cover and open the cover. Using vacuum cleaner or tightly squeezed cloth, clean thoroughly areas contaminated with dusts.

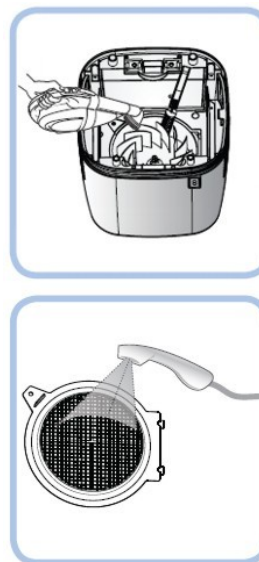

During the process take care not to wet the electrical connection or the motor part located under fan. Do not separate fan from the motor. Screw for cover separation (back side of the upper cover). Clean the fan cover and air blowing outlet around the fan using brush or vacuum cleaner. Wash fan cover by shower afterward. After cleaning, following reversal order of separation, close the upper part cover by pushing slightly in the four places until you hear the sound "click".

### 3.11 Cleaning (Plasma ion generator)

The air-blowing part would be cleaned periodically once in every year.

If the product is used in highly contaminated area, please clean once every 6 months.

Caution: Always disconnect power before cleaning the product.

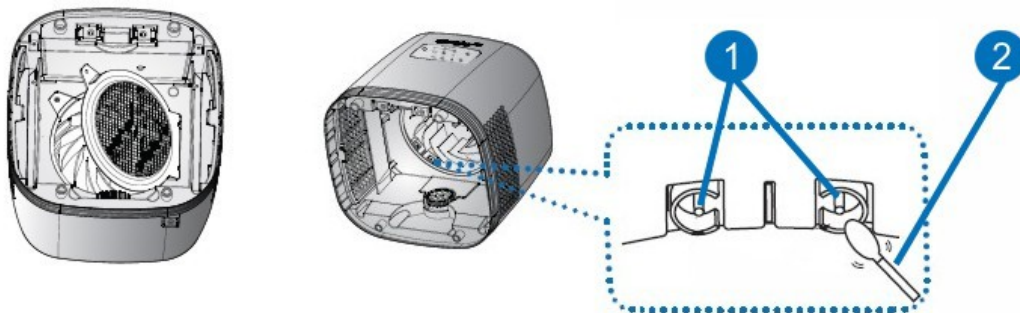

Using (+) screwdriver, first loosen the screw at the rear part of upper cover and uncover by putting upward.

Using cotton bud (2) selling at the market, remove dust at the end of electrode (1) with care.

Caution

1. If it is hard to wipe the spot on the lense, clean the lense with a light wet cotton swab. Then wipe the lense with a dry cotton swab.
2. Do not clean with thinner, benzene or alcohol. It might occur the lense's damage.
3. After cleaning, reassemble the sensor cover to its original position.

## 4 Troubleshooting and fixing problems

### Criteria to check before requesting for service.

Condition	Criteria check
<b>Strange sound</b>	<ol style="list-style-type: none"> <li>1) Are you operating it on a flat surface and not on a decline? <ul style="list-style-type: none"> <li>• Designate a flat surface and move it to that location.</li> </ul> </li> <li>2) Are there articles that block the flow of air around the product? <ul style="list-style-type: none"> <li>• Remove the article that obstructs the operation around the product.</li> </ul> </li> <li>3) Have you assembled the upper part and the lower part cistern without unnecessary space? <ul style="list-style-type: none"> <li>• Match the front part of the cistern lower part with the front part of the upper part main body (console)</li> </ul> </li> </ol>
<b>Fan does not turn</b>	<ol style="list-style-type: none"> <li>1) Does the direction of the upper part main body and the lower part cistern match? <ul style="list-style-type: none"> <li>• Match the frontside of the lower part cistern with the upper part of main body frontside (console)</li> </ul> </li> <li>2) Are there any holes between upper part main body and the lower part cistern? <ul style="list-style-type: none"> <li>• The upper part main body and the lower part cistern have to be adjacent without any holes in order to operate properly.</li> </ul> </li> <li>3) Do you see the 'out-of-water' sign? <ul style="list-style-type: none"> <li>• If the water goes below the minimum line, the operation stops.</li> <li>• The operation starts again if you supply water.</li> </ul> </li> <li>4) Are there any sticks or foreign materials stuck around the fan area? <ul style="list-style-type: none"> <li>• Due to carelessness, if there are any foreign materials stuck around the fan area, remove them.</li> </ul> </li> <li>5) In sleeping mode, the fan stops if the room humidity exceeds 60%.</li> <li>6) Haven't you pressed stop button? Please press the power button on the left.</li> </ol>
<b>Disks do not turn</b>	<ol style="list-style-type: none"> <li>1) For the upper part of the main frame and the lower part of the cistern do the direction match and are they placed correctly? <ul style="list-style-type: none"> <li>• Match the upper part main body frontside (console) with the lower part cistern frontside.</li> </ul> </li> <li>2) For inside the product, are the disks placed in its correct location and direction? <ul style="list-style-type: none"> <li>• Please adjust the disc to be set into its original place.</li> </ul> </li> <li>3) Is the cap for the disk assembly loose? <ul style="list-style-type: none"> <li>• Please turn the cap clockwise to fasten it.</li> </ul> </li> <li>4) In automated/sleeping mode, the fan stops if the room humidity exceeds 60%.</li> <li>5) Haven't you stopped the operation? <ul style="list-style-type: none"> <li>• Please press the power button on the left.</li> </ul> </li> </ol>

### Frequently asked questions.

Main inquiry	Content
<b>The water level does not decrease</b>	<ol style="list-style-type: none"> <li>1) According to the seasons, the surrounding moisture conditions, temperature and others, the evaporation amount can differ. <ul style="list-style-type: none"> <li>• For summer, area of high moisture or low temperature, the evaporation of the water decreases.</li> </ul> </li> <li>2) The product does not function properly. <ul style="list-style-type: none"> <li>• For [the fan does not turn] and [the disks do not turn] please follow the recommended measures.</li> </ul> </li> </ol>
<b>Is it really humidifying?</b>	<ul style="list-style-type: none"> <li>• The airwasher is a natural evaporating humidifier. Unlike the general humidifier, which forces the water to atomize using the ultrasonic-wave method or the multiple method product, you cannot see the results.</li> <li>• You might not feel the humidifying effect of the airwasher for first several</li> </ul>



	<p>days of using it. This is because the surrounding environment like furniture, bed, floor, or wallpaper absorbs the moisture.</p> <p>You may start to feel the optimally humidified environment after a week.</p> <p>Please check the humidifying ability through the water decrement.</p>
<b>Is the humidifying effect good?</b>	<ul style="list-style-type: none"> <li>• It has better humidifying ability than ultrasonic or heating humidifier since it reaches fast to optimal humidity level.</li> <li>• Also, unlike the atomizing process of the ultra-sonic method, the area around the humidifier does not become damp.</li> </ul>
<b>Can you breathe comfortably?</b>	<ul style="list-style-type: none"> <li>• Due to the atomizing condition of the ultra-sonic method, the water particles make breathing difficult.</li> <li>• For the natural humidifying method, even if the moisture rises, there is no discomfort for breathing due to the natural status of the moisture maintaining method.</li> </ul>
<b>Does the air become purified?</b>	<ul style="list-style-type: none"> <li>• For much of the odor of the air, it can easily dissolve by alcohol in the water. The airwasher, which uses water as a pure filter, helps to eliminate toxic gases.</li> </ul>
<b>How often do I have to resupply water in the cistern?</b>	<ul style="list-style-type: none"> <li>• Supply water below the water level mark as you see the 'out-of-water' display. (once a day or two days).</li> <li>• The water resupply differs with the surrounding moisture, temperature and situation.</li> </ul>
<b>Can the water in the cistern become disinfected?</b>	<ul style="list-style-type: none"> <li>• By the disinfectant device (BSS: Bio Silver Stone), more than 99.9% can be disinfected so there is no need for any worry.</li> <li>• But, please be sure to wash surely one time a week.</li> </ul>
<b>The color of the disinfectant device has changed!</b>	<ul style="list-style-type: none"> <li>• This is due to the silver ionization of oxygen in the disinfectant device (BSS) and it will have no effect on the function whatsoever.</li> </ul>
<b>Does the contaminated water evaporate?</b>	<ul style="list-style-type: none"> <li>• Even if the water of the cistern is contaminated by the dust or foreign materials, only pure water is humidified so there is no need for any worry.</li> </ul>
<b>I found the (%) display blinking.</b>	<ul style="list-style-type: none"> <li>• Most of the case, it is due to temporary error in sensing interior humidity. Try to unplug the power cord for 10 seconds and reconnect it. If the problem persists, please call our customer service.</li> </ul>
<b>Can I add perfume (aroma) products?</b>	<ul style="list-style-type: none"> <li>• As a phenomenon damaging or breaking the surface can occur by reacting with plastic products, please don't use it.</li> </ul>
<b>It smells.</b>	<ul style="list-style-type: none"> <li>• When dust and smell are severe according to a use environment and it is not washed more than one time per week (especially a rainy period), smell can be generated.</li> <li>• If you dissolve proper amount of Lux or a washing agent to water and wash it, the smell is removed</li> </ul>

**As a defect is not considered following:**

- Device works quietly but not completely silent. Noise less than 35 dB is normal.
- Humidity sensor works just as indicator. It means that ambient humidity can be different up to +/- 10%.

**Caution! If your device fails to work despite these tips, please contact the supplier from whom you purchased it.**

## 5 Technical specification

Description	Multifunctional air cleaner and humidifier
Model	AWE-25PTOH(CZ)
Electricity consumption	8 W

Max. humidifying capacity	250 ml/h
Cistern capacity	4,5 l
Product size	280 x 280 x 370 mm
Product weight	4,5 kg
Voltage, frequency	220-240 V, 50/60 Hz
Fan speeds	high / middle / low
Noise	30 db / 27 db / 24 db
Warranty	2 years

## 6 Waste disposal

---



This product has been manufactured using high-grade materials and components which can be recycled and reused.



The European directive 2012 / 19 / CE on Waste Electrical and Electronic Equipment (WEEE), requires that old household electrical appliances must not be disposed in the normal unsorted municipal waste stream. Old appliances must be collected separately in order to optimize the recovery and recycling of the materials they contain and reduce the impact on human health and the environment. The crossed out “wheeled bin” symbol on the product reminds you of your obligation, that when you dispose of the appliance it must be separately collected. Consumers should contact their local authority or retailer for information concerning the correct disposal of their old appliance.

All rights for any technical modifications are reserved

EU importer  
 Bibetus s.r.o.  
 Loosova 262/1, Brno 638 00, Czech republic  
 info@bibetus.cz